

ASUMMC

Medical Congress

APRIL 24th, 25th & 26th

44th

AIN SHAMS UNIVERSITY
MEDICAL CONGRESS

Triumph Katameya Hotel, New Cairo, Egypt



2024

Final
Program



TABLE OF *Content*

Board of the Congress	1
Guest Speakers	2
General Information	3
Audiovisual Instructions	4
Partners	5
Floor Plan	6 - 7
Scientific Program:	
Wednesday	8 - 41
Thursday	42 - 69
Friday	70 - 91

UNDER THE PATRONAGE OF



Mohamed Diaa Zain El-Abedeem, MD

PRESIDENT OF AIN SHAMS UNIVERSITY

CONGRESS BOARD



Ali Al-Anwar, MD

DEAN OF FACULTY OF MEDICINE,
AIN SHAMS UNIVERSITY
PRESIDENT OF THE CONFERENCE



Hala Sweed, MD

VICE DEAN FOR COMMUNITY SERVICES & ENVIRONMENTAL
DEVELOPMENT FACULTY OF MEDICINE, ASU
VICE PRESIDENT OF THE CONFERENCE



Amro Elhoussieny, MD

HEAD OF GYNECOLOGY & OBSTETRICS DEPARTMENT
FACULTY OF MEDICINE, ASU
CONFERENCE MODERATOR

GUEST Speakers

-  Aimen Shaaban
-  Amaal Asad
-  Amr Emara
-  Anna Vorndran
-  Assaf Al-Assaf
-  Ayman El-Badry
-  Carlos Gine
-  Elizabeth Montgomery
-  Eman Abou Bakr
-  Emma Houlder
-  Fan Zhining
-  Hao Xu
-  Jerry Vockley
-  Maryellen Gusic
-  Maysa El-Hussaini

-  Mohamed El-Houdaiby
-  Mohamed Hamdy
-  Mohamed Hassanien
-  Mohamed Shagrani
-  Mohammed Afifi
-  Samer El-Lahham
-  Sami El-Boghdadly
-  Sarah Walker
-  Sondus Hassounah
-  Sonia Hammami
-  Tyler Hughes
-  William E.Hills
-  Xiao Bin
-  Yaser Hosny Ali Elewa

GENERAL Information

Venue: Triumph Luxury Hotel

Address: Block 19 in front of Katameya Heights Road, Cairo, 11861

Language: All conference sessions are in English with no instant translation.



Organizational Notes:

- Please wear the name tag throughout your stay at the conference.
- Please ensure having your cellular phone on flight mode or silent inside the scientific hall.
- Registration desk will start on Wednesday 24th of April 2024 at 08:00 AM

Certificates: Certificates to be delivered digitally three weeks after the congress.

Weather Forecast:

-Wednesday: 42/23 C

-Thursday: 36/21 C

-Friday: 32/20 C

Organized by: IRIS

Day	Temp	Humidity	RealFeel	Max UV Index	RealFeel Shade	Wind
WED 4/24	42° / 22°	0%	42°	6 High	40°	SW 15 km/h
Sun through high clouds and very hot						
THU 4/25	33° / 19°	0%	32°	5 Moderate	31°	NW 19 km/h
Rather cloudy and cooler; breezy in the afternoon						
FRI 4/26	31° / 18°	1%	31°	11 Extreme	29°	N 22 km/h
Turning cloudy and breezy						

AUDIOVISUAL *Instructions*

The Conference hall will be equipped with:

- A Laptop with Microsoft Windows and Microsoft Office
- Internet access will **NOT** be available inside the meeting rooms.
- All presentations should be recorded on a **USB flash memory (preferred)** or **CD-R**.
- Please save presentation in **PowerPoint** .
- Upload your presentation early to the **Audiovisual center** as we will load the presentations to the hard drive of our systems before the session by one hour.
- Personal laptops will not be permitted.
- Presentations are monitored by a **count-down timer**; make sure to stick to your time frame.
- In case you have problems with your presentation; please do not hesitate to contact **IRIS IT support team**.



**UPON REACHING THE TIME LIMIT OF YOUR LECTURE THE SCREEN
AND MICROPHONE WILL GO SILENT.**

PARTNERS

PLATINUM



GOLD



SILVER



BRONZE



FLOOR Plan

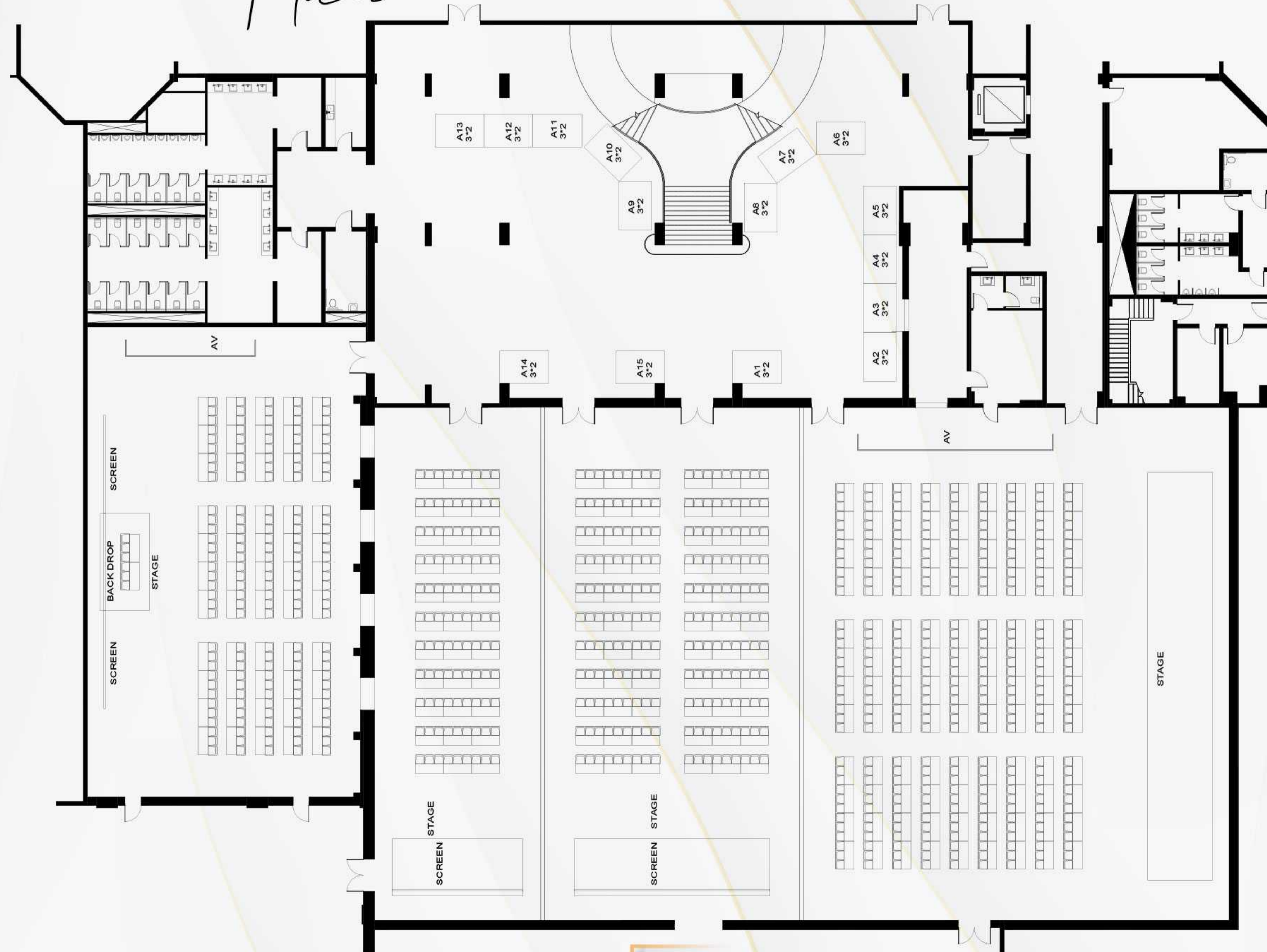

FLOOR

Plan

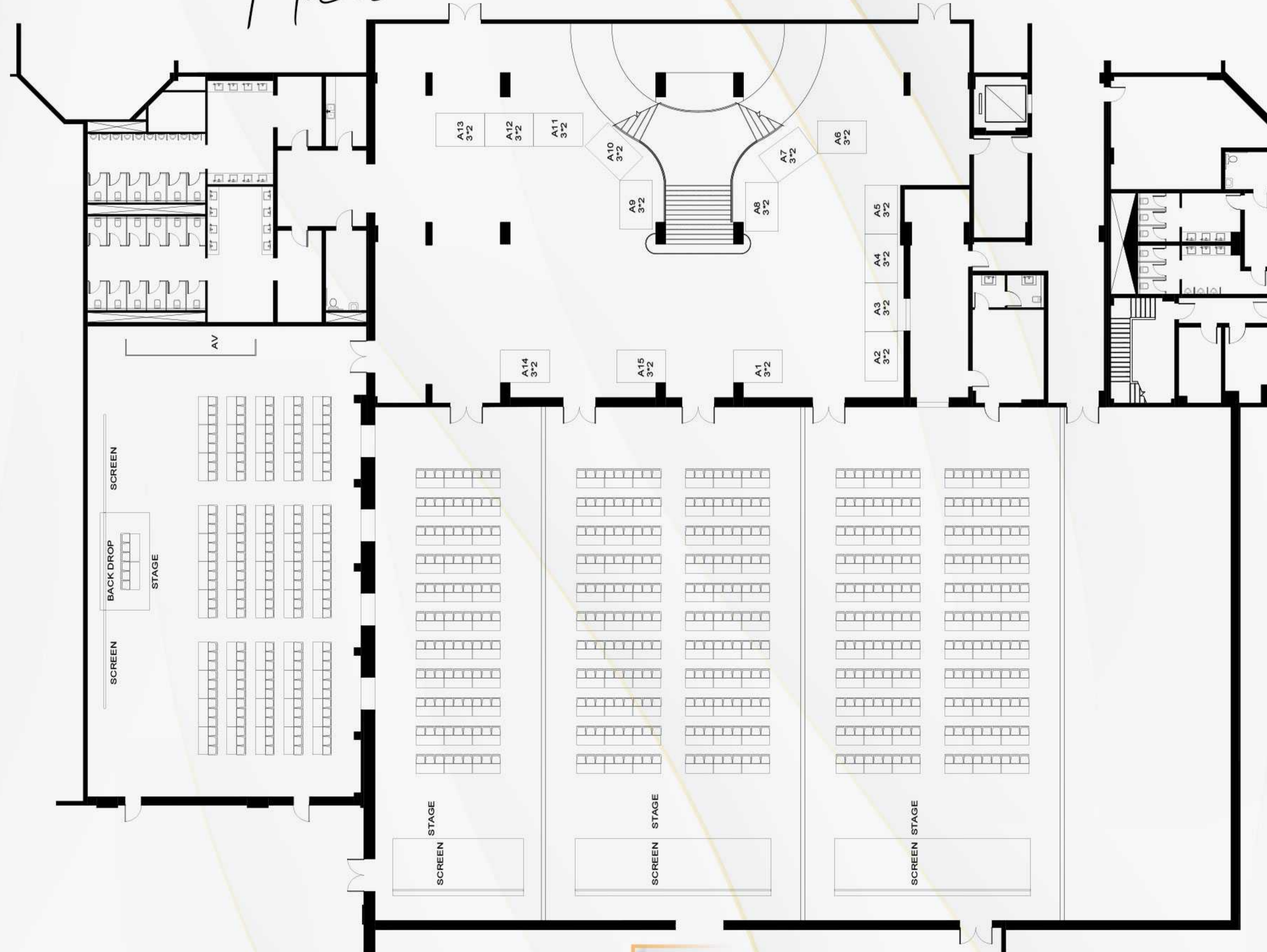

Wednesday 24 April 2024



09:00 - 10:30

AMERICAN COLLEGE OF SURGEONS

CHAIRPERSONS

- Ahmed Aly Khalil** Professor of General Surgery - ASU
- Alaa Ismail** Professor of General Surgery - ASU
- Hasan Shaker** Professor of General Surgery - ASU
- Mohey Elbanna** Professor of General Surgery - ASU
- Tyler Hughes** Dean of Kansas School of Medicine, Vice President of the American College of Surgeons

20 min	The Importance of Rural Surgery in a Specialized World	Tyler Hughes	Dean of Kansas School of Medicine, Vice President of the American College of Surgeons
15 min	Doctor – Patient Relationship	Alaa Ismail	Professor of General Surgery - ASU
15 min	Robotic Colorectal Surgery: Ain Shams Experience	Ahmed Aly	Professor of General Surgery - ASU
15 min	Trauma Evaluation & Management	Abdelhakeem T. Elkholy	Director of Egyptian Life Support Training Center (ELSTC), Chief of Region 17, ACS Regional Committee on Trauma
10 min	Change Initiation and Management in Healthcare Institutions	Mohey Elbanna	Professor of General Surgery - ASU
10 min	Women in Surgery in Ain Shams University	Dina Hany	Assistant Professor of General Surgery, ASU
5 min	Discussion		

Wednesday 24 April 2024



10:30 – 12:15

ENDOMETRIOSIS: THE MULTIDISCIPLINARY TEAM MANAGEMENT

CHAIRPERSONS

- Ahmed Aly Professor of General Surgery - ASU
- Hatem El-Gamal Professor of Gynecology & Obstetrics – ASU
- Hassan Shaker Head of Urology Department - ASU
- Hazem Sammour Professor of Gynecology & Obstetrics – ASU

15 min	Radio: Diagnostic Modalities of Endometriosis	Rasha Salah	
15 min	Gyn: DIE: New Era in Laparoscopic Interventions	Amro Elhoussieny	Head of Gynecology & Obstetrics – ASU
15 min	GS: Role of Colorectal Surgery in the Management of Endometriosis in the MDT Era	Tarek Youssef	Professor of General Surgery, ASU, CEO of Ain Shams University Hospitals
15 min	Endometriosis: The Urological Aspect	Hassan Shaker	Head of Urology Department - ASU
15 min	The Structured Approach to Excision of Deep Endometriosis	Hassan Morsi	
15 min	Medical Treatment of Endometriosis – Sponsored by Techno	Amro Elhoussieny	Head of Gynecology & Obstetrics – ASU
15 min	Discussion		



Wednesday 24 April 2024



12:30 – 14:00

GENERAL SURGERY - HBP SESSION

CHAIRPERSONS

- Mahmoud Elmeteini** Professor of General Surgery, Director of Transplantation Program - ASU
- Mohamed Bahaa** Professor of General Surgery, ASU
- Mohamed Fathy** Professor of General Surgery, ASU
- Tyler Hughes** Dean of Kansas School of Medicine, Vice President of the American College of Surgeons

15 min	Thinking like a leader		Tyler Hughes	Dean of Kansas School of Medicine, Vice President of the American College of Surgeons
15 min	LDLT in Ain Shams Universtiy: 1500 Cases over 2 Decades		Mahmoud Elmeteini	Professor of General Surgery, Director of Transplantation Program - ASU
15 min	Guidelines for the Management of Liver Trauma		Mohamed Fathy	Professor of General Surgery -ASU
15 min	Guidelines for the Management of Biliary Tract Tumors		Mohamed Bahaa	Professor of General Surgery – ASU
15 min	Roux-en-Y isolated Biliary Limb vs. Conventional Reconstruction after Pancreatic Head Resection - A Novel Technique		Hatem Sayed	Professor of General Surgery- ASU
15 min	GE Symposium: Agile Hybrid Labs - AI Assisted ORs		Ahmed Taher	GE Healthcare IGS Modality Leader

Wednesday 24 April 2024



14:00 – 15:30

GENERAL SURGERY - UGI SESSION

CHAIRPERSONS

Ashraf Fawzy Professor of General Surgery - ASU
Ashraf Kamal Professor of General Surgery - ASU
George Abdelfady Professor of General Surgery, Head of the Upper GI and Bariatric Surgery Unit - Cairo University
Hesham Maged Professor of General Surgery - ASU

15 min	Laparoscopic cardioplasty for management of achalasia: when and how to do?	Mohamed Abdelmageed	Assistant Professor of General Surgery - ASU
15 min	Persistent Dysphagia after Heller's Myotomy for Achalasia: Management Challenges	Mohamed Ibrahim	Professor of General Surgery -ASU
15 min	Laparoscopic Management of Epiphrenic Diverticulum	Tarek Abozeid	Assistant Professor of General Surgery - ASU
15 min	Minimally Invasive Esophagectomy and Gastric Conduit Neck Anastomosis in cases of Post-corrosive Esophageal Stricture (challenges and pitfalls)	Mohamed El-Serfy	Assistant Professor of General Surgery - ASU
15 min	Minimally Invasive Esophagectomy	Mohamed Mahfouz	Professor of General Surgery -ASU
15 min	Progress in Treatment of Gastric Cancer	Hao Xu	Professor of Upper GI Surgery Jiangsu Province Hospital, the First Affiliated Hospital with Nanjing Medical University, Nanjing, China

Wednesday 24 April 2024



15:30 – 16:45

BARIATRIC SURGERY SESSION

CHAIRPERSONS

Ahmed Ibrahim Professor of General Surgery, Head of the Bariatric Surgery Unit - ASU
Mahmoud Zakaria
Mohey Elbanna Professor and Head of the Department of General Surgery - ASU
Osama Fouad

15 min	New Trends in Metabolic Intervention	Ahmed Ibrahim	Professor of General Surgery, Head of the Bariatric Surgery Unit - ASU
15 min	GERD after Bariatric Surgery	Haitham El Maleh	Professor of General Surgery - ASU
15 min	Roux-en-Y Gastric Bypass for patients with GERD after Sleeve Gastrectomy	Mahmoud Zakaria	Professor of General Surgery - ASU
15 min	Fundus-enforced OAGB/MGB	Osama Fouad	Professor of General Surgery - ASU
15 min	Bariatric Procedures for Non-Bariatric Indications	Mohey Elbanna	Professor and Head of the Department of General Surgery – ASU

Wednesday 24 April 2024



09:00 – 10:15

ANATOMY

CHAIRPERSONS

Haidy Farid Professor of Anatomy & Embryology-Head of Anatomy Department - ASU
Hamdy Mohamady Professor of Anatomy & Embryology - ASU
Khaled Naeim Professor of Anatomy & Embryology - ASU
Shahira Youssef Professor of Anatomy & Embryology - ASU

15 min	Honoring Ceremony		
30 min	Parkinson's Disease Segmental Mechanism of Allodynia (Neuropathic Pain)	Aziz Hafidi	Associate Professor of Neuroscience
30 min	Botox Injection to Facial Muscles: Possible Emotional and Mental Hazards based on Developmental Facts	Abdou Mohammed Ahmed El-Sharkawy	Professor of Anatomy & Embryology-Head of Anatomy Department -Al -Azhar University

Wednesday 24 April 2024



10:15 – 12:00

ANATOMY

CHAIRPERSONS

Hoda Mahmoud Professor of Anatomy & Embryology - ASU
Kamal Asaad Professor of Anatomy & Embryology - ASU
Soheir Ibrahim Professor of Anatomy & Embryology - ASU

30 min	Use of Script Concordance test as a tool for Clinical Reasoning in Teaching applied Anatomy and Clinical Embryology	Hany Waheeb	Professor of Anatomy & Embryology - ASU
30 min	Using the Unreal Game Engine for Teaching and Learning	Ahmed Farid Al-Naklawy	Associate Professor of Anatomy - ASU. Head of Clinical Sciences Dep. & MBBS Director - Fakeeh College of Medical Sciences - KSA
30 min	Role of AI in Teaching Anatomy.	Gamal Taha	Associate Professor of Anatomy & Embryology - ASU
15 min	Student's Contribution: AI in Medical Research: Redefining Timelines and Enhancing Efficiency	Mustafa Ashraf	

Wednesday 24 April 2024



13:30 - 15:15

CARDIOLOGY – MULTIDISCIPLINARY PRESENTATIONS

CHAIRPERSONS

- Amro Elhoussieny** Head of Obstetrics & Gynecology Department - ASU
- Amr Saad** Lecturer of Gynaecology & Obstetrics - ASU
- Dahlia Abdelmohsen** Professor of Internal Medicine - ASU
- Dina Salem** Professor of Clinical Oncology - ASU
- Essam Abdelwahed** Professor of Hematology - ASU
- Ghada Selim** Professor of Cardiology - ASU
- Hebatallah Attia** Professor of Cardiology - ASU
- Hossam Salah** Assistant Professor of Rheumatology & Rehabilitation Medicine - ASU
- Kamal Okasha** Professor of Nephrology - Tanta University
- Khaled Said** Professor of Cardiology - ASU
- Mahmoud Soliman** Professor & Head of the Cardiology Department - Menoufyia University
- Nireen Okasha** Head of Cardiovascular Department - ASU
- Ramzy El-Mawardy** Professor of Cardiology – ASU
- Wael El-Kilany** Professor of Cardiology – ASU
- Walaa Adel** Professor of Cardiology – ASU

30 min	Cardiology in Women	Hebatallah Attia	Professor of Cardiology - ASU
	Case Presentation	Mahmoud Soliman	Professor of Cardiology – Menofiya University
		Amr Khaled	Asst. Lecturer – Cardiology Department - ASU
15 min	Cardiology & DM	Adel El-Etriby	Professor of Cardiology - ASU
15 min	Cardiology & Obesity	Yasser Alaa	Professor of Cardiology - ASU
15 min	Cardio-Hematology	Ahmed Shawky	Professor of Cardiology - ASU
15 min	Cardio-Oncology	Ahmed Kadry	Professor of Cardiology - ASU
15 min	Cardio-Nephrology	Naema Mashout	Asst. Lecturer of Cardiology - ASU

Wednesday 24 April 2024



15:15 - 15:45

SANOFI SYMPOSIUM **sanofi**

CHAIRPERSON

Nireen Okasha Head of Cardiovascular Department - ASU

15 min	Strike Early Strike Strong: PCSK9 Inhibitors in Lipid Management	Nireen Okasha	Head of Cardiovascular Department - ASU
15 min	Road To Recovery: "ACS Patient Journey".	Tamer Abo-Arab	Professor of Cardiology - ASU

15:45 - 17:00

HOT TOPICS IN CARDIOLOGY

CHAIRPERSONS

Adham Abdeltawab Professor of Cardiology - ASU
Ahmed Onsy Professor of Cardiology - ASU
Alaa Roshdy Professor of Cardiology - ASU
Ayman Morttada Professor of Cardiology - ASU
Hayam El-Damanhoury Professor of Cardiology - ASU

Khairy Abdeldayem Professor of Cardiology - ASU
Khaled Aly Professor of Cardiology - ASU
Mazen Tawfik Professor of Cardiology - ASU
Mohamed Zahran Professor of Cardiology - ASU
Wagdy Galal Professor of Cardiology - ASU
Yasser Gomaa Professor of Cardiology - ASU

15 min	SDI in the Young	Lamya Allam	Professor of Cardiology - ASU
15 min	Molecular Advances in Cardiovascular Medicine	Mostafa Nawagy	
30 min	What do Cardiologists need to know from the intensivist !!	Sameh Salem	Professor of Anaesthesiology
15 min	High Flow O2 Delivery Devices in Patients with Cardiomyopathy	Mahmoud Mohsen	Asst. Professor of Chest - ASU

Wednesday 24 April 2024



17:00 – 17:30

CARDIO NUTRITION

CHAIRPERSONS

Ghada Selim	Professor of Cardiology - ASU
Hazem Khorshid	Professor of Cardiology - ASU
Walaa Adel	Professor of Cardiology - ASU
Yasser Alaa	Professor of Cardiology - ASU

30 min	Come and Try Healthy Diet	Adel Shabana	Professor of Cardiology - ASU
--------	---------------------------	--------------	-------------------------------

17:30 – 18:00

UNDERGRADUATE CARDIO LEAGUE

30 min	Undergraduate Cardio League	Hayam El-Damanhoury	Professor of Cardiology - ASU
--------	-----------------------------	---------------------	-------------------------------

Wednesday 24 April 2024



18:00 – 19:00

MY BEST CASE

CHAIRPERSONS

Ahmed Abdelrahman Professor of Cardiology - ASU
Ahmed Nassar Professor of Cardiology - ASU
Azza El-Fiky Professor of Cardiology - ASU
Diaa Kamal Professor of Cardiology - ASU
Ghada El-Shahed Professor of Cardiology - ASU

Maiy Hamdy El-Sayed Professor of Cardiology - ASU
Mohamed Awad Taher Professor of Cardiology - ASU
Nabil Farag Professor of Cardiology - ASU
Ramez Guindy Professor of Cardiology - ASU
Sameh Thabet Professor of Cardiology - ASU
Tamer Abou Arab Professor of Cardiology - ASU

12 min	PCI	Tarek Rashid	Professor of Cardiology - ASU
12 min	PCI	Mohamed Zahran	Professor of Cardiology - ASU
12 min	TAVI	Ahmed Kayaly	Lecturer of Cardiology - ASU
12 min	Congenital	Amira Nour	Lecturer of Cardiology - ASU
12 min	EP	Ahmed Gamal	Lecturer of Cardiology - ASU

Wednesday 24 April 2024



19:00 – 19:45

CARDIOLOGY FROM THE PSYCHIATRIC PERSPECTIVE

CHAIRPERSONS

Adham Abdeltawab	Professor of Cardiology - ASU
Afaf Hamed	Professor of Psychiatry - ASU
Ahmed El-Ghalid	Professor of Cardiology - Suez Canal University
Ghada Selim	Professor of Cardiology - ASU
Mahmoud El-Habiby	Professor of Psychiatry - ASU
Marwa El-Messiry	Professor of Psychiatry- ASU
Omar Awaad	Professor of Cardiology - ASU
Tarek Okasha	Professor of Psychiatry - ASU
Walaa Adel	Professor of Cardiology - ASU

12 min	Psycho-Cardiology Continues	Ahmed El-Ghalid	Professor of Cardiology – Suez Canal University
12 min	Exploring the Holistic View of Health and Wellness	Ghada Selim	Professor of Cardiology - ASU
12 min	Stress and Well-Being among Medical Students (Insights from Ain Shams)	Adham Abdeltawab	Professor of Cardiology - ASU
12 min	As Faculty and Administrators, can we do better, listen to the Experts	Mahmoud El-Habiby	Professor of Psychiatry

19:45 – 20:15

EXTRA-CURRICULAR TOPIC – الحضارة المصرية القديمة

Wednesday 24 April 2024



09:00 – 9:45 PHYSIOLOGY

CHAIRPERSONS Bataa El-Kafoury Professor of Physiology, Former Head of Physiology Department - ASU
 Ebtessam Abo Shady Professor of Physiology, Former Head of Physiology Department - ASU
 Gehan Hamed Professor of Physiology - ASU
 Mona Ahmed Professor of Physiology - ASU

15 min	Opening Ceremony		
15 min	Physiological Changes of Sleep from Infancy to Elderly.	Shrouk	Teaching Assistant – Physiology – ASU
15 min	Relationship between Sleep Patterns Early in Life and Brain Development	Fatma Salma Remon	Teaching Assistant – Physiology – ASU Teaching Assistant – Physiology - ASU Teaching Assistant – Physiology - ASU

09:45 – 10:30 PHYSIOLOGY

CHAIRPERSONS Ahmed Kamel Professor of Physiology, Former Head of Physiology Department - ASU
 Ibrahim El-Mohamady Professor of Physiology, Former Head of Physiology Department – Cairo University
 Mohamed Haidera Professor of Physiology Department – Cairo University
 Yasser El-Wazir Professor of Physiology – Suez Canal University

15 min	Role of Gut Brain Axis in Sleep Regulation	Amy Fakhry Boushra	Associate Professor of Medical Physiology – Fayoum University
15 min	Sleep in Elderly from Theory to Practice	Heba Tawfeek	Asst. Professor of Geriatric –ASU
15 min	Sleep Deprivation Aggravates Myocardialinfarction	Samar	Asst. Lecturer – Physiology - ASU

Wednesday 24 April 2024



10:30 – 11:30

PHYSIOLOGY

CHAIRPERSONS

Abdel Aziz Hussein Head of Physiology Department – Mansoura University
Ahmed Abdel Tawab Professor of Physiology – Beni Suef
Ahmed Maher Professor of Physiology – Cairo University
Amany Ameen Head of Physiology Department – Fayoum University

15 min	The Effects of Sleep and Sleep Deprivation on Metabolic, Endocrine, and Immune Parameters	Abdallah	Teaching Asst. Physiology – ASU
15 min	Sex Differences of Insomnia-induced Metabolic Changes	Gehad	Asst. Lecturer of Physiology – ASU
15 min	Sleep Quality and Mental Health	Abdallah	Teaching Asst. Physiology – ASU
15 min	Sleep and Substance Use Disorders	Nahla Nagy	Professor of Neuropsychiatry - ASU

Wednesday 24 April 2024



13:30 – 14:15 PHYSIOLOGY

CHAIRPERSONS

Abdel Rahman Fahmy Head of Physiology Department - AFCM
Ahmed Emad Head of Physiology Department – Russian University
Ayman Elsaied Professor of Physiology – Beni Suef University
Hossam Awad Professor of Physiology – ASU
Shereen Elaraby Head of Physiology Department – Zagazig University

15 min	Maternal Sleep and Fetal Pregnancy Outcome?	Nermeen Bastawy	Asst. Professor of Physiology – Cairo University
15 min	Effects of Sleep Apnea on Central Nervous System.	Nahed	Professor of Neuropsychiatry - ASU
15 min	Sleep Deprivation Disturbs Uterine Contractility and Structure in Pregnant Rats: Role of Matrix Metalloproteinase 9 and Transforming Growth Factor-β	Shimaa Hadhod	Asst. Professor of Physiology – Zagazig University

14:15 – 15:00 PHYSIOLOGY

CHAIRPERSONS

Ansam Seif Professor of Physiology – ASU
Bataa El-Kafoury Professor of Physiology - Former Head of Physiology - ASU
Mona Ahmed Professor of Physiology - ASU
Nehal Bahgat Head of Physiology Department - ASU
Saher Elagaty Professor of Physiology - ASU

15 min	Sleep Paralysis	Ahmed Gadallah	Asst. Professor of Physiology - Al-Azhar University - Assiut
15 min	Impact of Hypocretin (Orexin) on Sleep Physiology Disorders	Tarek Shoukry	Lecturer of Physiology – Cairo University
15 min	Autophagy and Sleep	Mira	Asst. Professor of Physiology – Cairo University

Wednesday 24 April 2024



15:00 – 16:45

PHYSIOLOGY (YOUNG PHYSIOLOGISTS)

CHAIRPERSONS

Ansam Seif	Professor of Physiology - ASU
Enas Abdel Aziz	Professor of Physiology – ASU
Gehan Hamed	Professor of Physiology – ASU
Nehal Bahgat	Head of Physiology Department - ASU
Saher Elagaty	Professor of Physiology – ASU

15 min	Importance of 3Rs implementation in animal experiments	URAF	Presentative of URAF (Animal Facilities)
15 min	Effect of Dysbiosis on Sleep	Yasmeen - Asmaa	Teaching Assistants – Physiology - ASU
15 min	Gut Microbiota, Role on Healthy Sleep, Sleep Disorders	Yasmeen - Asmaa	Teaching Assistants – Physiology – ASU
15 min	Exploring the Impact of Rapid Eye Movement Behavior Disorder on Senior Health.	GU Students	Medical Students – Galala University
15 min	Impact of Health Factors on Patients Dealing with Circadian Rhythm Disorder	GU Students	Medical Students – Galala University
15 min	Effect of Sleep Duration on Cognitive Functions	GU Students	Medical Students – Galala University
15 min	Closing Session		

Wednesday 24 April 2024



09:00 - 11:25

**PATHOLOGY DEPARTMENT
FIND YOUR NEW APPROACH TO THE DIAGNOSIS**

CHAIRPERSONS

Ahmed Abd El-Aziz	Professor of Pathology - Cairo University
Karima Sidhom	Professor of Pathology - ASU
Magda El-Monayeri	Professor of Pathology - ASU
Nahed Khamis	Professor of Pathology - ASU
Nedal Hegazy	Professor of Pathology - ASU
Zenab Kamar	Professor of Pathology - ASU

15 min	Welcome Speech	Manal Fawzy	Head of Pathology Department - ASU
15 min	Approach to Testicular Biopsy	Nafissa El-Badawy	Professor. of Pathology - ASU
15 min	Mimics in Dermatopathology	Naglaa Samir	Professor. of Pathology - ASU
15 min	Diagnostic Approach to Soft Tissue Tumors	Hoda Abou Gabal	Professor. of Pathology - ASU
15 min	WHO Reporting System for Lung Cytopathology	Fatma Samy	Asst. Professor. of Pathology - ASU
15 min	Germ cell tumor where you do not expect to see.	Maysa El-Hussaini	Professor. of Pathology – King Hussein Cancer Center – Jordan
15 min	Oh, the errors that we can make. Some mistakes and how to avoid them (Virtual)	Elizabeth Montgomery	Professor. of Pathology – Miami University - USA
15 min	Honoring Ceremony		

Wednesday 24 April 2024



11:40 – 14:15

PATHOLOGY DEPARTMENT ONCO-BIOMARKERS: WHEN, WHY AND HOW?

CHAIRPERSONS

- Hala Agina** Professor of Pathology, Executive Manager of Center of Research & Medical Education Development , Faculty of Medicine, Benha University
- Hala Naguib** Head of Anatomic Pathology Department - Cairo University.
- Magda Hassan** Professor of Pathology - ASU
- Manal El-Mahdy** Professor of Pathology - ASU
- Nashwa Emara** Professor of Pathology Department - School of Medicine, Benha University
- Nermine Ehsan** Professor of Pathology - National Liver Institute, Menoufia University

15 min	The Role of Pathologist in Selection and Interpretation of the Cancer Molecular Tests: A Practical Approach.	Somia Saad Eldin	Asst. Professor of Pathology - ASU
15 min	EGFR Testing in Lung Cancer	Mervat El-Deftar	Professor of Pathology – National Cancer Institute – Cairo University
15 min	Updates on PDL-1 Testing	Shady Elia Anis	Professor of Pathology - Cairo University
15 min	Triple Negative Breast Lesions	Lobna Shash	Professor of Pathology - ASU
15 min	ALK D5F3 Testing in Lung Cancer	Shimaa El-Gohary	Asst. Professor of Pathology - ASU
15 min	MMR testing: Tips and Pitfalls	Maysa El-Hussaini	Professor of Pathology – King Hussein Cancer Center – Jordan
15 min	Insights of international medical students ASU on Pathology course	Mohammed Al-Shaghdri Lama Al-Omar Payal Vijay Under supervision of Prof. Nayera Mostafa	International Medical Students - Yemen International Medical Students - Syria International Medical Students - India Director of the International Students' Office
50 min	Interactive Case Presentation- Live Microscopy	Maysa El-Hussaini	Professor of Pathology – King Hussein Cancer Center – Jordan

Wednesday 24 April 2024

Impetia

14:45 - 16:00

ENDOCRINOLOGY SESSION

CHAIRPERSONS

Ahmed Bahaa	Professor of Internal Medicine and Endocrinology - ASU
Aliaa El-Sherbiny	Professor of Internal Medicine and Endocrinology - ASU
Fadila Gad-Allah	Professor of Internal Medicine and Endocrinology - ASU
Laila Hendawy	Professor of Internal Medicine and Endocrinology - ASU
Maha Hassan	Professor of Pediatrics - ASU
Manal Abo Shady	Professor of Internal Medicine and Endocrinology - ASU
Rania Sayed	Professor of Internal Medicine and Endocrinology - ASU
Salah El Halawany	Professor of Internal Medicine and Endocrinology - ASU
Salwa Seddik	Professor of Internal Medicine and Endocrinology - ASU

15 min	Updates in management of Thyroid Cancer	Mark Nabil	Lecturer of Internal Medicine and Endocrinology
15 min	Refractory Hypothyroidism	Sherif Samy	Lecturer of Internal Medicine and Endocrinology
15 min	Thyroid emergency in pregnancy	Ghada Atef	Lecturer of Internal Medicine and Endocrinology
15 min	Updates in Management of Thyroid Nodules	Bassem Mourad	Assistant Professor of Internal Medicine and Endocrinology - ASU
15 min	OPH: Recent Updates in Screening of Diabetic Retinopathy	Marwa Othman	Lecturer of Ophthalmology - ASU

Wednesday 24 April 2024



16:00 – 17:15

PERT: MULTIDISCIPLINARY PULMONARY EMBOLISM RESPONSE TEAM

CHAIRPERSONS

Abdel Rahman Mohamed

Aya Abdel Dayem

Head of Chest Department - ASU

15 min	Vasc: PERT Concept & Needs for ASU Hospitals	Emad Hussein	Professor of Vascular Surgery - ASU
15 min	Chest: Pulmonary Hypertension Post-acute PE: Mechanisms & Management	Ahmed Adel	Lecturer of Chest Diseases - ASU
15 min	Cardiac Surgery: Surgical Management of CTEPH Chronic Thromboembolic Pulmonary Hypertension	Ahmed Helmi	
15 min	AN: Role of ECMO Team in Massive & Submassive PE	Adel Al Ansary	Professor of Anaesthesia, Intensive Care and Pain Management - ASU
15 min	Chest: Pulmonary hypertension in pregnancy	Aya Abdel Dayem	Head of chest Department - ASU

Wednesday 24 April 2024

Imperia

17:30 – 19:00

ADVANCES IN EMERGENCY MEDICINE AND CRITICAL CARE

CHAIRPERSONS

Ahmed Farouk
Wael Samir

Professor of Orthopedic Surgery - ASU

15 min	GS: Management of Polytraumatized patients in the Casualty: General Surgery Perspective	Mohamed Matar	Professor of General Surgery - ASU
15 min	VASC: Limb Trauma	Emad El-Din Hussein	
15 min	Ortho: Management of Polytrauma Patient.	Ahmed Saeed Younis	Lecturer of Orthopedic Surgery - ASU
15 min	AN: Individualization versus Protocolization in ICU	Sameh Salem	Propessor of Anaesthesia, Intensive Care and Pain Management - ASU
15 min	Forensic: Novel Validated Method of Gas Chromatography FID for Measuring Ethanol and Methanol in Acute Methanol Toxicity	Mohamed Abdel Azim	Fellow of Biochemistry, Chromatography Unit, Poison Control Center - ASU
15 min	AN: Postpartum Delirium in ICU	Noura M. Yousri	Professor of Anaesthesia, Intensive Care and Pain Management - ASU

Wednesday 24 April 2024



09:00 - 10:30

**MICROBIOLOGY DEPARTMENT
 SESSION I: INFECTION PREVENTION & CONTROL:
 STRATEGIES FOR A SAFER HEALTHCARE ENVIRONMENT.**

CHAIRPERSONS

- | | |
|-------------------|--|
| Ahmed Sadeq | Professor of Medical Microbiology and Immunology - Assuit University |
| Inas Abdel Mageed | Professor of Medical Microbiology and Immunology - Assuit University |
| Nesreen Omar | Professor of Medical Microbiology and Immunology - Mansoura University |
| Noha Nagy | Professor of Medical Microbiology and Immunology - ASU |
| Zeinab Nabil | Professor of Medical Microbiology and Immunology - Al-Azhar University |

15 min	Occupational Healthcare Personal Safety	Sayed El-Okda	Professor of Occupational Health - ASU
15 min	Stay Up to Date with COVID-19 Vaccines	Mona Adel	Professor of Medical Microbiology and Immunology - ASU
15 min	Shielding Life: Confronting IPC Challenges in Cancer Patients	Maha Hamdy	Head of Medical Microbiology and Immunology Department - ASU
15 min	Hospital Environmental Safety: Air Quality & Air Conditioning System	Gehan Fahmy	Professor of Clinical Microbiology - ASUSH
15 min	Response Strategies for Emerging and Targeted MDROs	Ahmed Morad	Professor of Medical Microbiology and Immunology - Zagazig University
15 min	War's Silent Fallout: Unleashing Infectious Diseases and the Imperative of IPC in Disaster Zones	Shimaa Abdel Salam	Professor of Medical Microbiology and Immunology - ASU

Wednesday 24 April 2024



10:30 - 11:45

**MICROBIOLOGY DEPARTMENT
SESSION II: EXPLORING THE FRONTIERS:
RECENT ADVANCES IN INFECTIOUS DISEASES**

CHAIRPERSONS

Ayman Asaad

Ensaf El-Azzazy

Nermeen Hassan

Reem Refaat

Assistant Professor of Medical Microbiology and Immunology - ASU

Professor of Medical Microbiology and Immunology - Zagazig University

Professor of Medical Microbiology and Immunology – Beni Suef University

Head of Medical Microbiology and Immunology Department - Banha University

15 min	Oncogenic Role of Bacterial Infections in Cancer	Fatma Moustafa	Assistant Professor of Medical Microbiology and Immunology - ASU
15 min	Clinical Utility of AI in Microbiology Laboratory	Fatma El-Zahraa Youssef	Assistant Professor of Medical Microbiology and Immunology - ASU
15 min	Fecal Microbiota Transplantation: Harnessing the GUT Microbiome for Health	Mostafa El-Feshawy	Consultant of Infectious Diseases, IDCARE Organizer
15 min	Engineered Bacteria for Drug Delivery: Principles & Future Possibilities	Makram Fahmy	Professor of Medical Microbiology and Immunology - ASU
15 min	Revolutionizing Infectious Disease Treatment: Recent Breakthroughs in Immunotherapies	Kawthar Ibrahim	Assistant Professor of Medical Microbiology and Immunology - ASU

Wednesday 24 April 2024



12:30 – 13:45

VASCULAR SURGERY

CHAIRPERSONS

- Ayman Abdelfattah** Head of Vascular Surgery Department
Professor of Vascular Surgery - ASU
- Mohamed Haggag** Lecturer of Vascular Surgery - ASU
- Mostafa Emam** Lecturer of Vascular Surgery - ASU
- Mostafa Soliman** Professor of Vascular Surgery - ASU
- Sherif Essam** Professor of Vascular Surgery - ASU

15 min	Women Health in Vascular Surgery.	Mohamed Haggag	Lecturer of Vascular Surgery - ASU
15 min	Use of Popliteal Brachial Pressure Index as a Predictor of Wound Healing after Below knee Amputations with absent Popliteal Pulse	Omar Hassanein	Lecturer of Vascular Surgery - ASU
15 min	Predictors for Primary Functional Maturation for Autogenous avfs	Mohamed Osama	Lecturer of Vascular Surgery - ASU
15 min	Aortic Surgery Experience with Royal Brompton	Sherif Essam	Fellow of the Royal College of Surgeons in Ireland, Professor of Vascular Surgery - ASU
15 min	Pediatric Low Flow Extremities Vascular Malformation Pediatric Sclerotizing Kits	Mohamed Talaat	Lecturer of Vascular Surgery - ASU

Wednesday 24 April 2024



14:00 – 15:15

RHEUMATOLOGY, REHABILITATION & PHYSICAL MEDICINE 1

CHAIRPERSONS

Amal El-Ganzoury

Head of Rheumatology, Rehabilitation, and Physical Medicine - ASU

Hanaa Fathy

Professor of Rheumatology, Rehabilitation, and Physical Medicine - ASU

Heba Elshamy

Professor of Rheumatology, Rehabilitation, and Physical Medicine - ASU

Mahmoud El-Tayeb

Professor of Rheumatology, Rehabilitation, and Physical Medicine - ASU

Mohamed Gamal Zaki

Professor of Rheumatology, Rehabilitation, and Physical Medicine - ASU

20 min	HLAB27 Syndrome (Virtual)	Eman Abou Bakr	Professor of Rheumatology, Rehabilitation, and Physical Medicine - UAE
20 min	Interstitial Lung Disease in Autoimmune Rheumatic Disease	Rehab Ali	Asst. Professor of Rheumatology, Rehabilitation, and Physical Medicine - ASU
20 min	Management of Collagen Related Interstitial Lung Disease (ILD)	Eman Khater	Lecturer of Chest Diseases, - ASU

Wednesday 24 April 2024



15:15 – 16:15

RHEUMATOLOGY, REHABILITATION & PHYSICAL MEDICINE 2

CHAIRPERSONS

Hanan Elsebaie Professor of Rheumatology, Rehabilitation, and Physical Medicine - ASU
Nadia Elarousy Professor of Rheumatology, Rehabilitation, and Physical Medicine - ASU
Ola Abdelnaser Professor of Rheumatology, Rehabilitation, and Physical Medicine - ASU

PANALISTS

Nahed Moawad Associate Professor of Clinical Hematology and Bone Marrow Transplant - ASU
Nevine Fouda Professor of Rheumatology, Rehabilitation, and Physical Medicine - ASU

20 min	CAR T Cell Therapy in Refractory Rheumatic Diseases	Nayera Zaghlol	Professor of Rheumatology, Rehabilitation, and Physical Medicine - ASU
30 min	Microangiopathies: Challenging Cases: Case Presentation	Aya Hamed	Lecturer of Rheumatology, Rehabilitation, and Physical Medicine -ASU

Wednesday 24 April 2024



16:15 – 17:00

RHEUMATOLOGY, REHABILITATION & PHYSICAL MEDICINE 3

CHAIRPERSONS

Dina Abubakr	Assistant Professor of Rheumatology, Rehabilitation, and Physical Medicine - ASU
Fatma Kamel	Professor of Rheumatology, Rehabilitation, and Physical Medicine - ASU
Manal Samir	Lecturer of Rheumatology, Rehabilitation, and Physical Medicine - ASU
Nevine Shaker	Professor of Rheumatology, Rehabilitation, and Physical Medicine - ASU

20 min	Fibromyalgia Stigma and its Impact	Abeer El Zoheiry	Professor of Rheumatology, Rehabilitation, and Physical Medicine - ASU
20 min	Overview on Elderly Rehabilitation	Takwa Badr	Professor of Rheumatology, Rehabilitation, and Physical Medicine - ASU

Wednesday 24 April 2024



09:00 - 10:30 UNESCO CHAIR ON BIOETHICS CONFERENCE

20 min	Only Bioethics Can Save Lives in the Future Pandemics	Bahaa Darwish	Professor of Philosophy – Minia University
20 min	Ethical Agent toward a Practical Solution for Ethical AI Harmony: Mitigating Concerns of Dominance	Mohamed Abdel Razek	Professor of Artificial Intelligence – Al-Azhar University
20 min	Overview of the Egyptian Law of Medical Research and its Executive Regulations	Azza Saleh Radwan	Professor of Clinical and Chemical Pathology – Theodor Bilharz Research Institute
20 min	Ethical Concerns of Gender Selection Procedures	Abeer Zayed	Head of Forensic Medicine & Clinical Toxicology – Nahda University
10 min	Discussion		

Wednesday 24 April 2024



10:30 – 12:10 UNESCO CHAIR ON BIOETHICS CONFERENCE

20 min	Informed Consent in Research and Medical Practice”	Hany Sleem	IRB Vice Chairman Coordinator of the Egyptian Network of Research Ethics Committees (ENREC)
20 min	Framework for Assessing Ethical Challenges, Digitization Risks, and Data Protection Throughout the Data Lifecycle	Wael Badawy	Professor of Artificial Intelligence – Egyptian Russian University
20 min	Defensive Medicine Practices among Physicians, Cairo	Walaa Talaat Mohamed	Lecturer of Forensic Medicine & Toxicology – ASU
20 min	Ethical Challenges Facing Health Care Workers During Pandemics - (The Learned Lessons from COVID-19)	Amany Abdelfattah Ahmed	Asst. Lecturer of Forensic Medicine & Toxicology - ASU
10 min	Discussion		
10 min	Closing Remarks		

13:45 – 14:30

SECRETS OF THE HEART

CHAIRPERSONS

Ahmed Samir
 Henaz Farouk

Professor of Radiology - ASU

Professor of Rheumatology, Rehabilitation, and Physical Medicine - ASU

15 min	Med bio: The Molecular Face of Lipoproteins in Cardiometabolic Diseases	Mai Khaled	Lecturer, Medical Biochemistry and Molecular Biology - ASU
15 min	Radio: Can AI in 2024 help in CVS imaging	Ahmed Samir	Professor of Radiology - ASU
15 min 10 min	Rheumatology, Rehabilitation and Physical Medicine: CVS Risk in Rheumatic Diseases	Sahar Fathi	Professor of Rheumatology, Rehabilitation, and Physical Medicine - ASU

Wednesday 24 April 2024



15:00 – 16:15

THE ART OF MEDICAL TRAINING

CHAIRPERSONS

- Diaa Marzouk** Professor of Community, Environmental and Occupational Medicine, and Former Head of Family Medicine Department - ASU
- Fekrya Salama** Professor of Gynecology & Obstetrics - ASU
- Mostafa El-Hodhod** Former Dean of Faculty of Medicine - October 6 University
- Rania Ahmed Salah** Prof. and Former Head of Pediatrics Department - ASU
 Vice Dean for Education and Student Affairs, Faculty of Medicine - ASU

15 min	MedEd: Training of Assessors – Virtual	Maryellen Gusic	Senior Advisor for Educational Affairs. Prof. of Medical Education and Pediatrics, University of Virginia School of Medicine - USA
15 min	MedEd: New Trends in Postgraduate Clinical Training	Ahmed Makhlof	Dean of Faculty of Medicine, Badr University Former Dean of Faculty of Medicine - Assiut University
15 min	Med Edu: The New National Interns Training Program: The Ain Shams Experience	Marwa Eldeeb	Prof. of Pediatrics, Faculty of Medicine, Director of Interns Training at Ain Shams University Hospitals
15 min	Gyn: From Silk Road to Butterfly Haven: Cultivating a Transformative Educational System for Growth and Innovation	Mohamed El-Houdaiby (Virtual) Sarah Walker	Consultant Obstetrician and Gynecologist, North Bristol NHS Trust, UK Senior Registrar, North Bristol NHS Trust, UK
15 min	Family Medicine: Mechanisms of Change: Understanding Physicians’ Responses to Performance Regulatory Interventions’ – Virtual	Sondus Hassounah	Senior Teaching Fellow in Public Health. Department of Primary Care and Public Health, Faculty of Medicine, Imperial College – London UK

Wednesday 24 April 2024



16:15 – 17:45

THE FUTURE OF MEDICINE NOW: EXPLORING THE NEW TECHNOLOGIES IN HEALTHCARE.

CHAIRPERSONS

Hoda Farid Wahba
Sonia Azab
Tarek El-Zayat

Professor of Geriatrics and Gerontology, Chief Medical Officer, Ain Shams Virtual Hospital
Professor of Forensic Medicine and Toxicology - ASU

15 min	CEOM : Essential Quality Standards of tele health	Sayed El-Okda	Professor of Occupational Health - ASU
15 min	Neurosurgery: Remote Mentoring in Ventricular Endoscopy. Use of Smart Glass and Smart links. Collaboration with Harvard University.	Assem M. Abdel-Latif	Asst. Professor of Neurosurgery and Pediatric Neurosurgery -- ASU
15 min	Forensic: Medicolegal Aspects of Telemedicine	Rania Hadhoud	Assistant Professor of Forensic Medicine and Toxicology - ASU
15 min	Geriatric Medicine: Redefining Healthcare Delivery: The Geriatric Clinic Experience	Hoda Farid Wahba	Professor of Geriatrics and Gerontology, Chief Medical Officer, Ain Shams Virtual Hospital
15 min	CEOM: A Novel "Well Baby Clinic Service" Mobile Application - Development and Evaluation	Noha Magdi	Asst. Lecturer of Epidemiology - ASU
15 min	Urology: Artificial intelligence and Chat GPT, What they add in Urology Practice	Ahmed Hefnawy	Lecturer of Urology – ASU

Wednesday 24 April 2024



18:00 – 19:30

THE FUTURE OF ARTIFICIAL INTELLIGENCE IN MEDICINE

CHAIRPERSONS

Dina Adel Fouad Professor of Clinical Pathology- ASU
Ghada Essam El-Din Professor of Community, Environmental and Occupational Medicine, and Head of Family Medicine Department. ASU
Randa Reda Mabrouk Director ASU MENA Faimer Regional Institute, Egypt
 Prof. of Clinical Pathology, ASU

15 min	Med Edu: Artificial Intelligence in Medical Education Quality Assurance	Nadia Badrawi	Expert in Quality Assurance and Medical Education Prof. of Pediatrics, Cairo University
15 min	Med Edu: The Role and Establishment of Artificial Intelligence Unit in Medical Education	Mohamed Hassanien	Advisor of Vice President for Academic Affairs, Head of Assessment Unit, College of Pharmacy, King Abdulaziz University, KSA
15 min	CEOM: Role of Artificial Intelligence in Evidence-Based Medicine: Opportunities and Challenges	Hanaa Abdel Wahab	National Nutrition Institute
15 min	Clinical Pathology: Artificial intelligence in Hematology	Mariam Fathy Abdelmaksod	Asst.Prof. of Clinical Pathology - ASU
15 min	Family Medicine: AI in PHC: A New Tool for Family Physicians and Patients	Mohamed Farouk Allam	Professor of Family Medicine - ASU
15 min	Medical Education: Knowledge and Attitude of Medical Faculty and Students Towards AI	Soha Ashry	Head of Medical Education Department Prof. of Forensic and Clinical Toxicology, Faculty of Medicine - ASU

Wednesday 24 April 2024



9:00 – 10:15

CHALLENGING CASES IN PEDIATRIC CLINICAL PRACTICE 1

CHAIRPERSONS

Ahmed Hamdy Professor of Pediatrics - ASU
Aliaa Kotby Professor of Pediatrics - ASU
Amal El-Faramawy Professor of Pediatrics - ASU
Elham Hosny Professor of Pediatrics - ASU
Hamed El-Khayat Professor of Pediatrics - ASU
Lereen Bahey Eldin Professor of Pediatrics - ASU

Manal Hamdy Professor of Pediatrics - ASU
May Nassar Professor of Pediatrics - ASU
Mostafa Elhodhod Professor of Pediatrics - ASU
Riham Elhousseiny Professor of Pediatrics - ASU
Walid El-Guindy Professor of Pediatrics - ASU
Zeinab Awad Professor of Pediatrics - ASU

15 min	Homosexuality: silent creeping epidemic	Mohamed El-Sawy	Professor of Pediatrics - ASU
15 min	Endocarditis... a new version after the pandemic	Marwa Waheed Abdelhady Nasef	Professor of Pediatrics - ASU
15 min	It Takes Two to Tango	Dina Ebrahim	Professor of Pediatrics - ASU
15 min	Infections in immune-compromised children	Marwa Wahid Tolba	Professor of Pediatrics - ASU
15 min	High output stoma: nutritional challenges: Case Presentation	Basma Abdel Nasser	Professor of Pediatrics - ASU
	High output stoma: nutritional challenges: What the guidelines say?	Marwa El-Sherif	Professor of Pediatrics - ASU
	High output stoma: nutritional challenges: Gastrointestinal perspective	Radwa Mohamed	Professor of Pediatrics - ASU

Wednesday 24 April 2024



10:15 – 11:30

CHALLENGING CASES IN PEDIATRIC CLINICAL PRACTICE 2

CHAIRPERSONS

Galila Mokhtar Professor of Pediatrics - ASU
Hesham Awad Professor of Pediatrics - ASU
Hoda Lotfy Professor of Pediatrics - ASU
Maha Hasan Professor of Pediatrics - ASU
Mohsen Elalfy Professor of Pediatrics - ASU

Nayera Hazaa Professor of Pediatrics - ASU
Nihal El Raggal Professor of Pediatrics - ASU
Randa Matar Professor of Pediatrics - ASU
Safinaz Elhabashy Professor of Pediatrics - ASU
Terez Bushra Professor of Pediatrics - ASU

15 min	ANEC in IDDM patient: Brain Eater !!	Omnia Samy	Professor of Pediatrics - ASU
15 min	Chronic lung abscess and recurrent abdominal pain	Sally Raafat Ishak	Professor of Pediatrics - ASU
15 min	OPH: Recent Updates in Screening of Retinopathy of Prematurity with Pediatrics	Mohamed Salah	Lecturer of Ophthalmology - ASU
15 min	Common presentation of a rare disease	Hagar Bilal	
15 min	Tailoring Care to Patients with Posterior Fossa Tumors	Assem M. Abdel-Latif	Asst. Professor of Neurosurgery and Pediatric Neurosurgery -- ASU

16:00 – 19:00

PUBLICATION WORKSHOP

60 min	Writing Skills	Ashraf Nabhan	Professor of Obstetrics and Gynecology Department, Faculty of Medicine, ASU
60 min	Sections of a Paper		
30 min	Publishing skills		
30 min	One-on-one Guidance		

Thursday 25 April 2024



09:00 – 10:30

OBESITY: THE MOTHER OF ALL EVIL

CHAIRPERSONS

Mohamed Abdelhamid
Mohamed Fahmy
Mohamed Saad
Zaynab Hefny

15 min	Internal Medicine: Recent Updates in Management of Obesity	Laila Hendawy	Professor of Internal Medicine and Endocrinology - ASU
15 min	Pediatrics: Childhood Obesity: The Growing Monster	Rasha Tarif Hamza	
15 min	Gyn: Addressing Obstetrics and Gynecological needs of Obese Women	Hatem Elgamal	Professor of Gynecology & Obstetrics and Head of Assisted Reproductive Unit - ASU
15 min	Tropical: Functional Approach to Obesity Management	Doaa Zakaria	
15 min	GS: Recent Trends in Metabolic and Bariatric Surgery	Ahmed Ibrahim	Professor of General Surgery and Head of the Department of General Surgery - ASU
15 min	Plastic: Post Massive Weight Loss Body Contouring	M. Mamdouh	

11:00 – 11:30

OPENING CEREMONY

Thursday 25 April 2024



11:30 – 13:15

FETAL AND NEONATAL SURGERY, THE FUTURE IS HERE.

CHAIRPERSONS

Ahmed Bassiouny Professor of Pediatric Surgery - ASU
Amro Elhoussieny Head of Obstetrics & Gynecology Department - ASU
Assem M. Abdel-Latif Asst. Professor of Neurosurgery and Pediatric Neurosurgery -- ASU
Karam Bayoumy Professor Obstetrics & Gynecology Department - ASU

15 min	Gyn: Establishing ASU Fetal Intervention Unit	Ayman Abou El-Nour	Professor of Gynecology & Obstetrics and Former Head of the Department of Obstetrics and Gynecology - ASU
15 min	Prenatal Management of Complex MC Twins	Aimen Shaaban	Professor of Pediatric surgery, Director of the Chicago Institute for Fetal Health - USA
15 min	Pediatric Surgery: Exit Procedures for Congenial Diseases	Aimen Shaaban	Professor of Pediatric surgery, Director of the Chicago Institute for Fetal Health - USA
15 min	Pediatric Surgery: Fetal Surgery Barcelona Experience	Carlos Gine	
15 min	Pediatric surgery: Neonatal Abdominal Wall Defects	Tarek Hassan - Ihab Shafie - Hany Emad	
15 min	Neurosurgery: Adaptation to MOMs Trial Recommendations, Fetal vs Neonatal MMC Repair	Assem M. Abdel-Latif	
	Discussion		

Thursday 25 April 2024



13:15 - 14:30

EVERY LIFE MATTERS: TAILORING SURGICAL CARE FOR THE FETUS, NEWBORN, AND CHILD

CHAIRPERSONS

Ahmed Bassiouny Professor of Pediatric Surgery – ASU
Hany Hamed
Karam Bayoumy Professor of Obstetrics & Gynecology - ASU
Mohamed Elmandouh Professor of Obstetrics & Gynecology – ASU

15 min	Prenatal and Postnatal Treatment of Congenital Diaphragmatic Hernia	Aimen Shaaban	Professor of Pediatric surgery, Director of the Chicago Institute for Fetal Health, USA
15 min	Pediatric Surgery: Prenatal and Postnatal Management of Congenital Lung Diseases	Aimen Shaaban	Professor of Pediatric surgery, Director of the Chicago Institute for Fetal Health, USA
15 min	Pediatric Surgery: Fetoscopic treatment of neural tube defects.	Carlos Gine	
15 min	Pediatric Surgery: Neonatal Anorectal Malformation	Amr Zaky Ahmed Bassiouny Nader Nassif	
15 min	Urology: Practice and Experience a Pediatric Urologist should Acquire	Mohamed Kotb	

Thursday 25 April 2024



15:00 – 16:45

**INNOVATIONS IN SURGICAL TECHNIQUES:
 MINIMALLY INVASIVE AND ROBOTIC SURGERY**

CHAIRPERSONS

- Amr Khairy** Professor of Orthopedic Surgery - ASU
- Mona Kotb** Professor of Forensic Medicine and Clinical Toxicology - ASU
- Mohamed Amer** Professor of Obstetrics & Gynecology - ASU
- Omar Hammad** Professor of Neurological and Spine Surgery, ASU

15 min	Gyn: Laparoscopic Myomectomy	Amro Elhoussieny	Head of Gynaecology & Obstetrics Department – ASU
15 min	GS: Ain Shams Experience in Robotic Surgery and Future Expectations	Mohammad Ahmad Abd-erRazik	Associate Professor of General Surgery - ASU
15 min	Ortho: Robotic surgery .. The Future of Arthroplasty	Haytham Abdel Azim	Professor of Orthopedic Surgery - ASU
15 min	Tropical: Innovations in GIT endoscopy: Single use Endoscopy. Do we need it?	Ahmed Nagah	
15 min	Neurosurgery: Minimal Invasive Endoscope Spine surgery, from Inception to Practice.	Omar Hammad	Professor of Neurological and Spine Surgery - ASU
15 min	Neurosurgery: Advances in Ventricular Endoscopy for Treatment of Hydrocephalus	Hassan Jalalod'din	Professor of Neurological and Spine Surgery - ASU
15 min	Forensic: Ethical Horizons: Navigating Precision in Robotic Surgery	Noha El-Rafie	Forensic Toxicologist and Medical Educator, Vice Director of Grants Office - ASU

Thursday 25 April 2024



17:15 – 19:00

WOMEN HEALTH

CHAIRPERSONS

- Dina Salem** Professor of Clinical Oncology - ASU
- Ghada Essam El-Din** Head of Family Medicine Department, and Professor of Community, Environmental and Occupational Medicine, - ASU
- Ghada Refaat** Professor of Clinical Oncology - ASU
- Sahar Fathi** Professor of Rheumatology, Rehabilitation, and Physical Medicine - ASU
- Yasser Galal** Professor of Obstetrics & Gynecology - ASU
- Yasser Fouad** Professor of Forensic Medicine and Head of Forensic Medicine and Clinical Toxicology Department - ASU

15 min	Gyne: Cervical carcinoma early detection and prevention	Amro Elhoussieny	Head of Obstetrics & Gynecology Department - ASU
15 min	Gyne: Missed Abortion what to Know about the Management.	Sobhi Aboulouz	Professor of Obstetrics & Gynecology - ASU
15 min	Family Medicine: Development of Egyptian Practice Guidelines for peripartum Depression in Primary Health Care	Nourhan El Guindy	Asst. Lecturer of Family Medicine - ASU
15 min	Derma: Female Sexual dysfunction	Abdel Rahman El Wakeel	
15 min	Infection Control: Perinatal Care for Women with Blood Borne Pathogens	Nouran Madkour	Cosultant of Infection Control - ASUH
15 min	Rheumatology, Rehabilitation and Physical Medicine: Pregnancy Morbidities in SLE	Salwa Galal	Lecturer of Rheumatology, Rehabilitation, and Physical Medicine - ASU
15 min	Role of Egyptian Universities "Women Empowerment and Antiviolence Units	Hend El-Helaly	Professor of Clinical Toxicology - ASU

Thursday 25 April 2024



09:00 - 10:30

INFECTION CONTROL MISSION IN PROVIDING SAFE ENVIRONMENT - 1

CHAIRPERSONS

Amal El-Sayed Head of Infection Control Department
Ghada Abdelwahed Professor of Clinical Pathology SU- IPC SUCH
Maha El-Touny Professor of Internal Medicine - ASU
Shereen El-Masry Professor of Clinical Pathology and IPC Director - ASU

15 min	Opening		
15 min	IPC Mission for Safe Construction renovation in OR	Shereen El-Masry	Professor of Clinical Pathology and IPC Director - ASU
15 min	Optimization Of Infectious Waste Management In Hospitals	Ghada Ismail	Professor of Clinical pathology SU- IPC SUCH
15 min	I am Clean Initiative for Clean Hospital	Nagwa Khamis	Consultant of Infection Control - ASUSH
15 min	Assurance of Air Quality	Gihan Fahmy	Director of Infection Control - ASUSH
15 min	Role of IPC/WASH in Patient Safety in all Healthcare Settings (Virtual)	Anna Vordana	Infection Control Africa Network ICAN Secretary

Thursday 25 April 2024



11:30 - 12:45

INFECTION CONTROL MISSION IN PROVIDING SAFE ENVIRONMENT - 2

CHAIRPERSONS

Amany AbouElenin Professor of Clinical Pathology and IPC Director - Tanta University
Hala Badawy Professor of Microbiology - Theodore Belharz Institute
Heba Rashid Professor of Clinical Pathology – Assiut University
Mona Moheyeldin Professor of Clinical Pathology and IPC Team Leader - Cairo University
Sohair Abdelrahman Professor of Clinical Pathology and IPC Director - Banha University

15 min	Monitoring of Environmental Decontamination	Sally Moehy	IPC Director -MOH
15 min	MDR Environmental Control	Mona Wassef	Professor of Clinical Pathology Head of Department - Cairo University
15 min	When Infrastructure works for IPC	Nessrine Hanafy	IPC Director -Alexandria University
15 min	Role of Environment in Outbreak Investigations	Samia Abdou	Professor of Clinical Pathology and UPA Consultant - ASU
15 min	Recommendation Closing		

Thursday 25 April 2024



12:45 – 14:30

DELIVERING EXCELLENCE: THE VALUE-BASED CARE

CHAIRPERSONS

Ihab Shehad Professor.of Healthcare Quality - ASU
Mahi Al Tehewy Professor.of Healthcare Quality - ASU

15 min	Navigating in the Landscape of Value-based Care	Mahi Al Tehewy	Professor.of Healthcare Quality - ASU
15 min	Unleashing the Power of High Reliability Organizations in Healthcare (Virtual)	Samer El-Lahham	Professor, Cleveland Clinic - Abu Dhabi, UAE
15 min	Challenges Facing HC Organization in implementing Accreditation Standards	Ihab Shehad	Professor.of Healthcare Quality - ASU
15 min	Strategies to Enhance Patient Engagement in Value-Based Care (Virtual)	Sami El-Boghdadly	Asst. Professor - KANGMC, KSA
15 min	Technological Innovation in Value-Based Care	Tamer Emara	Professor, Director of Virtual Hospital, ASU, Egypt
15 min	Legal and Regulatory Risks in Healthcare (Virtual)	Assaf Al-Assaf	Professor of Healthcare Quality - Oklahoma University, USA
15 min	Discussion		

Thursday 25 April 2024



14:45 – 16:00

GENERAL SURGERY - COLORECTAL SURGERY SESSION

CHAIRPERSONS

Ahmed Aly Khalil Professor of General Surgery - ASU
Aser Afifi Professor of General Surgery - ASU
Essam Fakhry Professor of General Surgery - ASU
Mohamed Nada Professor of General Surgery - ASU
Tarek Youssef Professor of General Surgery - ASU

15 min	Colorectal Cancer Guidelines Updates	Mohamed Nada	Professor of General Surgery – ASU
15 min	Redo Surgery in Colorectal Cancer	Hany El-Barbary	Professor of General Surgery – ASU
15 min	Laparoscopic Right Hemicolectomy: Tips and Tricks	Sherif Abdelhaleem	Professor of General Surgery – ASU
15 min	Altemeyer Procedure for Strangulated Rectal Prolapse	Kareem Kamel	Lecturer in General Surgery - ASU
15 min	Perianal Fistula in Chron's Disease	Ihab Fadl	Professor of General Surgery - ASU

Thursday 25 April 2024

Monaco B

16:00 – 17:45

GENERAL SURGERY - BREAST SURGERY SESSION

CHAIRPERSONS

Mohamed Helmy Professor of General Surgery - ASU
Mohamed Sabry El-Kady Professor of Oncology - ASU
Osama El-Attar Professor of General Surgery - ASU

15 min	Tailoring the Surgical Management of Breast Cancer Patients in Ain Shams University Surgical Unit	Osama El-Attar	Professor of General Surgery - ASU
15 min	Targeted Axillary Lymph Node Dissection	Mohamed Khalaf	Professor of General Surgery - ASU
15 min	Bariatric Surgery and Considerations after Breast Cancer Patients	Karim Sabry	Professor of General Surgery - ASU
15 min	Role of Carbon Nanoparticles in Localization of Clipped Node - Case Presentation	Amira Maher	Lecturer in General Surgery – Galala University
15 min	Role of MDT in Tailoring Treatment in Early Breast Cancer	Mohamed Sabry	Professor of Oncology – ASU
15 min	Breast MDT Decision Making & Planned Interventional Radiology Solutions:	Ahmed Soliman	Asst. Professor of Radiology - ASU
15 min	Discussion		

Thursday 25 April 2024



17:45 – 18:30

ENDOCRINE SURGERY SESSION

CHAIRPERSONS

Abdelrahman Almaraghy
Ayman Abdrabo
Mahmoud Elshafei

Professor of General Surgery - ASU
Professor of General Surgery - ASU
Professor of General Surgery - ASU

15 min	Persistent or Recurrent Symptoms after Parathyroidectomy	Fady Hany	Lecturer in General Surgery - ASU
15 min	Different Approaches for Adrenalectomy and Cortical Sparing Adrenalectomy	Moustafa Nagy	Lecturer in General Surgery - ASU
15 min	Papillary Thyroid Carcinoma: Controversial Completion Thyroidectomy in Low Risk Cases	Mark Medhat	Asst. Lecturer General Surgery - ASU

Thursday 25 April 2024



09:00 – 10:30

CEOM

CHAIRPERSONS

Aisha Abou El Fetouh

Hoda Ibrahim Fahim

Iman Bakr

Mohsen Gadallah

Wagida Abdelrahman Anwar

Professor of Community, Occupational and Environmental Medicine - ASU

Professor of Community, Occupational and Environmental Medicine - ASU

Head of Department of Community, Occupational and Environmental Medicine - ASU

Professor of Community, Occupational and Environmental Medicine - ASU

Professor of Community, Occupational and Environmental Medicine - ASU

15 min	Metabolic Syndrome is it a Significant Health Problem in Africa?	Khaled Abdelaziz	Professor of Community, Occupational and Environmental Medicine - ASU
15 min	Preventing Obesity Among Children and Adolescents: a Child's Rights Approach	Naglaa Arafa	Asst. Professor of Community, Occupational and Environmental Medicine - ASU
15 min	Diabetes reversal: Is it a reality?	Ghada Wassif	Asst. Professor of Community, Occupational and Environmental Medicine – ASU
15 min	Prevalence and Risk Factors of Postpartum Depression among Women in a Primary Healthcare Unit	Lamyaa Al Bagoury	Asst. Professor of Community, Occupational and Environmental Medicine - ASU
15 min	Prevalence of Menstrual Associated Symptoms, Menstrual Hygiene Awareness and their Relation to School absenteeism among Secondary School Girls	Reem Alaa Kamel	Demonstrator of Community, Environmental and Occupational Medicine
15 min	Discussion		

Thursday 25 April 2024



11:30 – 12:45

CEOM

CHAIRPERSONS

- Ahmed Shuman Professor of Community, Occupational and Environmental Medicine - ASU
- Hisham Mahaba Professor of Community, Occupational and Environmental Medicine – ASU
- Mohamed El-Awady Professor of Community, Occupational and Environmental Medicine – ASU
- Nanice Ahmed Ismail Professor of Community, Occupational and Environmental Medicine – ASU
- Samia El-Damaty Professor of Community, Occupational and Environmental Medicine - ASU

15 min	Effects of Discrimination on a Sample of Medical International Students ASU	Nayera Samy Mostafa	Professor of Community, Occupational and Environmental Medicine - ASU
15 min	Work Related Stress, Anxiety and Depression among School Teachers in General Education	Maha Hussien Awad	Asst. Lecturer of Community, Occupational and Environmental Medicine - ASU
15 min	Post traumatic stress disorder and Quality of life among Egyptian Ambulance Workers	Asmaa Gamal Mansour	Asst. Lecturer of Community, Occupational and Environmental Medicine - ASU
15 min	Health System Resilience during Epidemics	Wagida Anwar	Professor of Community, Occupational and Environmental Medicine - ASU
15 min	Discussion		

Thursday 25 April 2024



12:45 – 13:45

CEOM

CHAIRPERSONS

Fatma Mekky

Maha El Gaafary

Mervat Hassan Rady

Sahar Sabbour

Professor of Community, Occupational and Environmental Medicine – ASU

Professor of Community, Occupational and Environmental Medicine – ASU

Professor of Community, Occupational and Environmental Medicine – ASU

Professor of Community, Occupational and Environmental Medicine - ASU

15 min	One Health Research: Improving Food Security, Safety and Resilience.	Abdelbary Prince	Professor of Biochemistry and Molecular Biology - Cairo University
15 min	Novel Molecular Mechanisms for Prevention and Treatment of Chronic Viral Hepatitis - (Immune Based Therapy)	Mohamed Mansour Saad Farag	Professor of Botany and Microbiology - Al-Azhar University
15 min	Health Technology Assessment – An economic perspective	Sahar Khalil	Professor of Community, Occupational and Environmental Medicine - ASU
15 min	Discussion		

Thursday 25 April 2024



14:00 – 15:15

UNLOCKING THE SECRETS OF LIVER HEALTH

CHAIRPERSONS

Hend Ebada

Asst. Professor of Community, Occupational and Environmental Medicine - ASU

Iman Montasser

Professor of Tropical Medicine - ASU

Karim Yehia Shaheen

Professor of Clinical Pathology - ASU

15 min	PATHOLOGY: Recent trends in liver pathology	Mariam Ibrahim	
15 min	Med Bio: Integrated Machine Learning/ Bioinformatic Towards Better Management of NAFLD	Marwa Matbouli	Professor Medical Biochemistry and Molecular Biology - ASU
15 min	Radio: pitfalls of Liver Imaging	Mikel Naguib Melad	
15 min	Clinical Pathology: Challenges and Future of Laboratory Diagnosis of Drug induced Liver Injury.	Dina Tharwat Ghanem	Lecturer of Clinical Pathology - ASU
15 min	Tropical: Unlocking the secrets of Fatty Liver Disease: Prevention, Treatment, and Recovery	Nadia Abdel Aty	Professor of Tropical Medicine - ASU

Thursday 25 April 2024



15:30 – 17:15

TROPICAL 1: WHAT'S NEW IN HEPATOLOGY, GASTROENTEROLOGY AND INFECTIOUS DISEASES?

CHAIRPERSONS

Ahmed Elkhateeb Professor of Tropical Medicine - ASU
Amani Ibrahim Head of Tropical Medicine Department - ASU
Eman Barakat Professor of Tropical Medicine - ASU
Mohamed Fawzy Professor of Tropical Medicine, Former Dean of Faculty of Medicine - ASU
Reda Elwakeel Professor of Tropical Medicine - ASU

MODERATOR

Sara Hassan Lecturer of Tropical Medicine – ASU

15 min	HIV Iceberg: what's new?	Heba Abdallah	Professor of Tropical Medicine - ASU
15 min	Emerging Medical Problems due to Natural Disasters and Wars: What's new?	Fatema Ali Eldeen	Professor of Tropical Medicine - ASU
15 min	IPMN: what's new?	Mohamed Salah	Asst. Professor of Tropical Medicine - ASU
15 min	Exocrine Pancreatic Insufficiency: what's new?	Manar Salah	Asst. Professor of Tropical Medicine – ASU
15 min	Protein-Losing Enteropathy: what's new?	Ahmed Al-Ganzoury	Lecturer of Tropical Medicine - ASU
15 min	NAFLD, MAFLD and MASLD: Are they different?	Hend Ebada	Asst. Professor of Tropical Medicine - ASU
15 min	Systemic Therapy in HCC: when and how to use?	Mohamed Kamal Shaker	Professor of Tropical Medicine - ASU

Thursday 25 April 2024



17:15 – 18:30

TROPICAL 2: UPPER GI NEOPLASIA - JOINT SESSION WITH NANJING UNIVERSITY

CHAIRPERSONS

- Ashraf Albreezy** Professor of Tropical Medicine - ASU
- Hany Dabbous** Professor of Tropical Medicine - ASU
- Hossam Salem** Professor of Tropical Medicine - ASU
- Mohamed Ibrahim** Lecturer of Tropical Medicine - ASU
- Tarek Youssef** Professor of Surgery - ASU
- Yasser Mohamed** Professor of Surgery - ASU

PANEL

- Essam Fakhry** Professor of Surgery - ASU
- Fan Zhining** GI Endoscopist, Digestive Endoscopy Department, Jiangsu Province Hospital the first affiliated hospital with Nanjing Medical University
- Hao Xu** Upper GI Surgeon, Jiangsu Province Hospital the first affiliated hospital with Nanjing Medical University
- Xiao Bin** GI Endoscopist, Pancreas Center, Jiangsu Province Hospital the first affiliated hospital with Nanjing Medical University

MODERATOR Mohammad Almohamady

15 min	Role of EUS in upper GI neoplasia	Xiao Bin	GI Endoscopist, Pancreas Center, Jiangsu Province Hospital the first affiliated hospital with Nanjing Medical University
15 min	Upper GI Neoplasia: Advances in Surgical Interventions	Hao Xu	Upper GI Surgeon, Jiangsu Province Hospital the first affiliated hospital with Nanjing Medical University
15 min	Cooperative approach for management of Upper GI SMT: (Endoscopic/Laparoscopic - Endoscopic/Thoracoscopic)	Fan Zhining	GI Endoscopist, Digestive Endoscopy Department, Jiangsu Province Hospital the first affiliated hospital with Nanjing Medical University
15 min	Case based discussion	Mohamed Almohamady	Lecturer of Tropical Medicine - ASU
15 min	Discussion		

Thursday 25 April 2024



18:30 – 20:00

EMPOWERING INDIVIDUALS TOWARDS OPTIMAL HEALTH

CHAIRPERSONS

Salma El-Said
Waleed Mousa

15 min	Micro: Discover the Complex Issue of Vaccine Hesitancy and its Impact on Immunization rates and Childhood Diseases.	Dina Erfan	Professor of Medical Microbiology and Immunology - ASU
15 min	Geriatrics: Health Promotion Guidelines in Elderly	Mona M Hegazy	Lecturer of Geriatrics and Gerontology - ASU
15 min	Geriatrics: Active ageing: The Concept and Applications	Nehal Magdi Abdul Mawla	Lecturer of Geriatrics and Gerontology - ASU
15 min	Derma: PRP Vs Non-cross-linked-HA in Management of Post-menopausal Sexual Dysfunction	Sylvia Ragy	Assistant Lecturer of Dermatology - ASU
15 min	Urology: Management of Geriatric urine Incontinence	Karim Omar	

Thursday 25 April 2024

Iceland

09:00 – 10:45

PARASITOLOGY - 1

CHAIRPERSONS

Hala Sobhy	Professor of Parasitology - ASU
Heba Abdel Aaty	Professor of Parasitology – ASU
Khalifa Elsayed Khalifa	Professor of Parasitology – ASU
Magda Azab	Professor of Parasitology – ASU
Maha Abougamra	Head of Parasitology Department - ASU
Nadia Eldib	Professor of Parasitology – Cairo University

15 min	Controlled Human Infection Model in Schistosomiasis (Virtual)	Emma Houlder	Leiden University Center for Infectious Diseases - Netherlands
15 min	Human Vaginome and Trichomonas Vaginalis the Silent Epidemics (Virtual)	Ayman El-Badry	Professor of Parasitology – Cairo University IAU, Saudi Arabia
15 min	Rethinking Novel and Re-emerging parasites: Future Global Threats Stop short of Causing Pandemics (Virtual)	Mohammed Afifi	Professor of Parasitology - Beni-Suef University King Abdulaziz University, Saudi Arabia
15 min	Is the New Malaria Vaccine a Game-Changer?	Hala Salah Elwakil	Professor of Parasitology – ASU
15 min	Protective Efficacy of Toxoplasma Gondii Infected Cells - Derived Exosomes Against Chronic Murine Toxoplasmosis	Gihan M. Tawfeek	Professor of Parasitology - ASU
15 min	Echinococcus Multilocularis First Time in Egypt	Mona Tolba	Professor of Parasitology – Alexandria University
15 min	The Effect of Nigella Sativa Oil- and Wheat Germ Oil- Loaded Metal Organic Frameworks on Chronic Murine Toxoplasmosis	Omnia Sobhi Mohammad	Lecturer of Parasitology - ASU

Each talk is 12 minutes followed by 3 minutes discussion.

Thursday 25 April 2024

Iceland

11:30 – 12:00

PARASITOLOGY – 2B

CHAIRPERSONS

Azza Younis	Professor of Parasitology – Cairo University
Fayza Habib	Professor of Parasitology - ASU
Gihan Mostafa	Professor of Parasitology – ASU
Ibrahim Rabie	Head of Parasitology Department - Tuodor Bilharz Institute
Khairy Abdelhamid	Professor of Parasitology and Vice Dean Sstudents Affairs – Al-Azhar University
Samia Eteawa	Professor of Parasitology – Zagazig University

15 min	Climate Change and Sustainability: A Perspective on Vector Borne Diseases	Noha Leboudy	Professor of Parasitology – ASU
15 min	RNA Vaccines in Parasitic Diseases	Abeer Fathy Badawy	Professor of Parasitology - ASU

Each talk is 12 minutes followed by 3 minutes discussion.

Thursday 25 April 2024



12:00 – 13:30

PARASITOLOGY – 3

CHAIRPERSONS

- Eman Mostafa Head of Parasitology Department – El-Fayoum University
- Enas Yehia Dean of Faculty of Medicine - Beni Suef National University
- Hala El-Wakil Professor of Parasitology - ASU
- Kholoud Elnouby Head of Parasitology Department - Tanta University
- Nancy Harba Head of Parasitology Department El-Monuifya University
- Samar Elbeshbishi Head of Parasitology Department - Mansoura University

15 min	Artificial Intelligence in Parasitic Diagnosis : a Threat or Opportunities	Hager Abdelmaksoud	Assistant Researcher Theodor Bilharz Research Institute
15 min	Does Tissue Eosinophilia Trigger Dysplasia in Schistosomiasis Can the pan-HDACi "SAHA" Antagonize it?	Marwa Adel Hasby	Assistant Professor - Tanta University
15 min	Stem Cell-Derived Exosomes as a Potential Therapy for Schistosomal Hepatic Fibrosis in Experimental Animals	Asmaa Rashad Ellakany	Lecturer of Parasitology - Tanta University
15 min	Crusted scabies in a rabbit model: a severe skin disease or more?	Mahmoud Shafik	Lecturer of Parasitology -Tanta University
15 min	The Contribution of in-silico Studies in Parasitology: A Multifaceted Approach (Virtual)	Asmaa Mostafa	Lecturer of Parasitology - ASU
15 min	Sero-molecular diagnosis of toxoplasmosis in Cancer patients, Sohag University Hospitals, Egypt: A case-control study (Virtual)	Eman Fathi Fadel Mohammad	Lecturer of Parasitology - Sohag University

Each talk is 12 minutes followed by 3 minutes discussion.

Thursday 25 April 2024



13:30 – 15:15

INBORN ERRORS OF METABOLISM (IEM) IN DIFFERENT SPECIALTIES

CHAIRPERSONS

Iman Aly	Professor of Pediatric Neurology - ASU
Mohamed Saad Zaghlol	Professor of Medical Genetics - ASU
Nahed Algareeb	Genetics and Metabolic Consultant, MOHP
Ola Ali Khalifa	Professor of Medical Genetics - ASU
Riham El-Hossiny	Professor of Pediatric Psychiatry - ASU
Solaf Mohamed Alsayed	Professor of Medical Genetics - ASU
Treiz Kamel	Professor of Pediatric Pulmonology - ASU



15 min	Global approach to IEM	Mohamed Alsawi	Professor of Pediatrics and Medical Genetics - ASU
15 min	Applied Genomics in Reproductive Medicine	Ezzat El-Sobky	Professor of Medical Genetics - ASU
15 min	How Cardiac Disease Presents in IEM?	Alyaa Kotbi	Professor of Pediatric Cardiology - ASU
15 min	IEM & the kidney	Ihab El-Hakim	Professor of Pediatric Nephrology - ASU
15 min	Pulmonary manifestations of IEM	Treiz Kamal	Professor of Pediatric Pulmonology - ASU
15 min	MR Spectroscopy in Neurometabolic Disorder	Khalid AboulFoutouh	Professor of Radiology - ASU
15 min	Occular Manifestations of IEM	Mohamed Rashad	Professor of Ophthalmology - ASU

Thursday 25 April 2024



15:15 – 16:45

**INBORN ERRORS OF METABOLISM (IEM) IN THE 21ST CENTURY:
PRESENT TO FUTURE**

CHAIRPERSONS

Ezzat Sayed El-Sobky
Hala Abdel Rahman
Howaida Al-Gebali
Mohamed Alsawi
Omnia Alrashidy
Sanaa Youssef
Solaf Mohamed Elsayed
Wael Bahbah

Professor of Medical Genetics - ASU
Genetics and Metabolic Consultant, MOHP
Dean of Faculty of Postgraduate Studies of Childhood - ASU
Professor of Pediatrics and Medical Genetics - ASU
Professor of Pediatric Neurology – ASU
Professor of Pediatric Nutrition – ASU
Professor of Medical Genetics - ASU
Professor of Pediatric Clinical Nutrition, MU

30 min	Newborn Screening for a New Century	Jerry Vockley	Professor of Human Genetics University of Pittsburgh – Pennsylvania, USA
15 min	Classical Homocystinuria: Current and Novel Therapeutic Approaches	Ola Ali Khalifa	Professor of Medical Genetics - ASU
15 min	Adolescent/Adult-onset Inherited Neurometabolic Disorders: A Great Challenge	Hoda Tomoum	Professor of Pediatric Neurology - ASU
15 min	Ketogenic Diet in IEM, Epilepsy and Beyond	Yasmin Gamal	Professor of Pediatric Nutrition - ASU
15 min	Discussion		

16:45 – 17:00 NUTRICIA SYMPOSIUM

15 min	Sponsored Lecture by Nutricia	Ahmed Eskander
--------	-------------------------------	----------------



Thursday 25 April 2024



17:00 – 18:45

LIVER TRANSPLANTATION (LTX): SHARING EXPERIENCE

CHAIRPERSONS

- Amr Abdel-Al Professor of General Surgery - ASU
- Hanaa Alkaraksi Professor of Pediatric Hepatology - CA
- Lerren Bahi Eldin Professor of Pediatric Hepatology – ASU
- Manal Hamdy Hamdy Professor of Pediatric Hematology – ASU
- Mohamed Al-Adawi Professor of Pediatric Hepatology – ASU
- Mohamed Shagrani Professor of Pediatric Hepatology, KFSH&RC - Riyadh, Saudi Arabia
- Ola Ali Khalifa Professor of Medical Genetics – ASU
- Solaf Mohamed El-Sayed Professor of Medical Genetics - ASU

15 min	The Role of Liver Transplantation in Management of IEM	Tawhida Yassin Abdel Ghaffar	Professor of Pediatric Hepatology - ASU
15 min	Outcome of liver Transplantation for Urea Cycle Disorders, KFSHRC, 11 years Experience	Mohamed Shagrani	Professor of Pediatric Hepatology, (KFSH&RC) - Riyadh, Saudi Arabia
15 min	Outcome of liver Transplantation for Organic Acidemias, KFSHRC, 11 years Experience	Mohamed Shagrani	Professor of Pediatric Hepatology, (KFSH&RC) - Riyadh, Saudi Arabia
15 min	Pediatric LDLTx in Egypt; History and Current Status.	Amr Abdel-Al	Professor of General Surgery – ASU
15 min	Liver Transplantation for Propionic Acidemia	Jerry Vockley	Professor of Human Genetics University of Pittsburgh – Pennsylvania, USA
15 min	Liver Transplantation for Methylmalonic Acidemia	Jerry Vockley	Professor of Human Genetics University of Pittsburgh – Pennsylvania, USA
15 min	Discussion		

Thursday 25 April 2024

Louvre 5

10:00 – 10:30

HISTOLOGY DEPARTMENT - 1

CHAIRPERSONS

Kawthar Farrag	Professor of Histology - ASU
Maher Mohamed Emara	Professor of Histology - ASU
Salwa Mohamed Abdel Tawab	Professor of Histology - ASU

15 min	Mitochondrial Dynamics in Health and Diseases	Amany Elshawarby	Professor of Histology - ASU
15 min	Can histological evidences of Diabetes precede clinical diagnosis??	Seham Kamal Mohamed Abounasef	Professor of Histology - ASU

Thursday 25 April 2024



11:30 – 13:15

HISTOLOGY DEPARTMENT - 2

CHAIRPERSONS

Fayka Hassan El-Ebiary

Professor of Histology - ASU

Hanan Alaa El-Din

Professor of Histology - ASU

Nevert Farid Abdel Salam

Professor of Histology - ASU

15 min	Turning Back the Biological Clock: Stem Cell Applications in Aging. Systemic Review	Shaimaa Mohamed Fattin	Lecturer of Histology – ASU
15 min	Mitochondrial Transfer in Physiological and Pathological Conditions	Amany Elshawarby	Professor of Histology - ASU
15 min	Autophagy as a Protective Mechanism in Type 2 Diabetes Mellitus	Faten Abdelzaher Mahmoud	Lecturer of Histology – ASU
15 min	The Effect of Aging on the structure of The Colon of Rat with Reference to Interstitial Cells of Canal	Dina Mohamed Rashad El Saied El Morsy	Asst. Lecturer of Histology – ASU
15 min	The Effect of Exosomes from Adipose Derived Mesenchymal Stem Cells on Photoaged Rat Skin Versus Topically Applied Growth Factors: A Histological Study	Mai Shehata Mohamed Hamed	Asst. Lecturer of Histology – ASU
15 min	Novel mediastinal immune clusters driving lung injury pathogenesis following inflammation or diabetic induction (Virtual)	Yaser Hosny Ali Elewa	Tenured Assist. Prof. Hokaido University -Japan
15 min	Discussion		

Thursday 25 April 2024

Louvre 5

13:30 – 15:30

CRISPR GENE EDITING-BASED THERAPY: CURRENT AND FUTURE

CHAIRPERSONS

Hamed El-Khayat

Maha Sallam

Mohamed Ayman Saleh

Mohamed Farid ElAsmr

Sanaa Eissa

Professor of Pediatric– ASU

Professor of Medical Biochemistry and Molecular Biology – ASU

Professor of Cardiology - ASU

Professor of Medical Biochemistry and Molecular Biology – ASU

Professor of Medical Biochemistry and Molecular Biology – ASU

20 min	CRISPR Gene Editing: Historical Basis, Current Status, and Promising Future	Amr S. Moustafa	Professor of Medical Biochemistry and Molecular Biology – ASU
20 min	CRISPR-Based Drugs for the treatment of Sickle cell anemia and β -Thalassemia	Said Yousuf	Professor of Internal Medicine and Hematology – ASU
20 min	CRISPR as a promising tool for the management of pediatric cancers	Fatma Ebeid	Professor of Pediatrics – ASU
20 min	CRISPR-Based Approach for the Management of Cardiovascular Disorders	Nabil Farag	Professor of Cardiology – ASU
20 min	CRISPR-Based Approach for the Management of Duchenne Muscular Dystrophy and Other Genetic Diseases	Solaf Mohamaed	Professor of Medical Genetics - ASU
20 min	Questions and Answers		

Thursday 25 April 2024



17:00 – 18:30

PANEL DISCUSSION: THE WET CHILD

CHAIRPERSONS

- Ahmed Bassiouny** Professor of Pediatric Surgery - ASU
- Aly Bersy** Professor of Pediatric Surgery – ASU
- Osama Naggar** Professor of Pediatric Surgery – ASU
- Sherif Soliman** Professor of Pediatric Surgery – ASU

15 min	The wet child: who, what and how? The Paediatric Urologist’s Perspective.	Sherif M Soliman	
15 min	Managing the wet adolescent: The paediatric Urologist’s Perspective	Mohamed Kotb	
15 min	The Spectrum of Neurodevelopmental disorders in wet Children and Adolescents: The dark side of the moon	Azza Youssef	
15 min	Antimicrobial policies in children with Bladder and Bowel Dysfunction: The Paediatric Nephrologist’s Perspective	Dina Ebrahim	
15 min	Managing Constipation/Soiling in BBD: Failure is not an Option	Ahmed Bassiouny	
15 min	The way forwards: Towards a Dysfunctional Voiding MDT Collaboration in Ain Shams	All Panelists	

Friday 26 April 2024



09:00 - 10:45

CANCER: THE STATE OF TODAY AND TOMORROW

CHAIRPERSONS

- Ahmed Ezzat Professor of Clinical Oncology - ASU
- Dina Salem Professor of Clinical Oncology - ASU
- Hagar Elghazawy Lecturer of Clinical Oncology - ASU
- Hosam Salem
- Lobna Ezz El-Arab Professor of Clinical Oncology - ASU
- Mohamed Abdel Rahman Professor of Orthopedic Surgery - ASU
- Waleed Abdel Aty
- Youssef Kotb Professor of Urology - ASU

15 min	MICRO: Basic Principles of Immunotherapy	Mona Adel	Professor of Medical Microbiology and Immunology – ASU
15 min	Geriatrics: Geriatric Oncology Patients: Optimizing Outcomes	Elham Raouf	Lecturer of Geriatrics and Gerontology - ASU
15 min	Ortho: Unusual Presentation in Orthopedic Oncology	Mohamed Mwafy	Lecturer of Orthopedic Surgery - ASU
15 min	Tropical Medicine: Role of Third Space Endoscopy in Treatment of Early GIT Cancers.	Mohammad Almohamady	
15 min	GS: Recent Trends in Detection and Management of Gastric Cancer	Mohamed El Serafy	
15 min	Oncology: Clinical Oncology Department: Long Story of Care and Success	Khaled Abdel Karim	Professor of Clinical Oncology - ASU
15 min	Urology: Organ Preservation Strategy in Management of Muscle Invasive Bladder Cancer MIBC (Virtual)	Mohamed Hamdy	

Friday 26 April 2024



10:45 - 12:00

DIABETES: DILEMMAS IN EVERY SPECIALTY

CHAIRPERSONS

Ahmed Bahaa
Ahmed Shaaban
Atef El-Beltagy
Mohamed Elwy
Salah El-Halawany
Tarek Abdel Azim

Professor of Clinical Pharmacology – ASU
Professor of Orthopedic Surgery - ASU
Professor of Rheumatology, Rehabilitation, and Physical Medicine - ASU

15 min	Pharma: Pharmacogenomic Implication in Antidiabetic Therapy	Ahmed Shaaban	Professor of Clinical Pharmacology – ASU
15 min	Internal Medicine: Updates in Diabetes Management	Sherihan Abo El-Yazid	
15 min	VASC: Care of Diabetic Foot Wounds	Shadi Mohamed	
15 min	Ortho: Dilemma of Charcot Arthropathy	Amr Farouk	Professor of Orthopedic Surgery – ASU
15 min	Rheumatology, Rehabilitation and Physical Medicine:: Diabetic Foot Management: Role of Rehabilitation	Rana El Hilaly	Professor of Rheumatology, Rehabilitation, and Physical Medicine - ASU

Friday 26 April 2024



14:00 – 15:30

MULTIDISCIPLINARY MANAGEMENT OF BREAST CANCER

CHAIRPERSONS

Eman Fouad	Professor of Clinical Oncology – ASU
Hany Abdel Aziz	Professor of Clinical Oncology – ASU
Manal Fawzy	Professor of Pathology – ASU
Mohamed Abdel Razik	Professor of Surgery – ASU
Mohamed Helmy	Professor of Surgery – ASU
Nevin Gado	Professor of Clinical Oncology – ASU
Nevin Shalaby	Professor of Radiology - ASU
Reda Abdel Tawab	Professor of Surgery – ASU

15 min	Breast Surgery in gBRCA MT Patients	Ahmed Gamal	Professor of Surgery – ASU
15 min	The Golden Value of Neoadjuvant Therapy in Breast Cancer	Hagar El-Ghazawy	Lecturer of Clinical Oncology - ASU
15 min	Why should clinicians know histologic types of breast cancer	Thanaa Helal	Professor of Pathology – ASU
15 min	Axillary nodal evaluation in breast CA patients	Ahmed Soliman	Professor of Radiology - ASU
15 min	Challenging Case Discussion	Ahmed Gamal Hagar El-Ghazawy	Professor of Surgery – ASU Lecturer of Clinical Oncology - ASU
10 min	Case discussion in MDT: the panel		

15:30 – 17:00

PANEL DISCUSSION: MULTIDISCIPLINARY MANAGEMENT OF PULMONARY CANCER

Friday 26 April 2024



17:15 – 18:45

TACKLING ANTIBIOTIC RESISTANCE: NOVEL APPROACHES AND THERAPEUTICS

CHAIRPERSONS

Mohamed Abdel Bary Professor of Clinical Pharmacology - ASU
Ramy Soliman Assistant Professor of Orthopedic Surgery - ASU
Samia Abdou Professor of Clinical Pathology - ASU

15 min	Infection control: Our Current Situations in Ain Shams University Hospitals and Active Steps	Sherine Elmasry	Professor of Internal Medicine - ASU
15 min	CEOM: Egyptian Action plan for Antimicrobial Resistance	Alaa Afdal	Antimicrobial Stewardship Consultant – EMRO - WHO
15 min	Clinical Pathology: Diagnosis of Antimicrobial Resistance for Tailoring Therapy	Omnia Mohamed	Professor of Clinical Pathology - ASU
15 min	MICRO: Combatting AMR: The Development of New Antimicrobial Arsenal	Reham Khalifa	Professor of Medical Microbiology and Immunology - ASU
15 min	Pharma: The new 4-month treatment regimen of TB	Mohamed Abdel Bary	Professor of Clinical Pharmacology - ASU
15 min	Ortho: Postoperative Antibiotic Prophylaxis and Antibiotic Resistance in Orthopedics	Tony Maher	Lecturer of Orthopedic Surgery - ASU

Friday 26 April 2024



09:00 – 10:15

EVOLVING SOLUTIONS IN NUTRITIONAL THERAPY

CHAIRPERSONS

Irene Raouf

Professor of Rheumatology, Rehabilitation, and Physical Medicine - AS

Mohamed Abdelbaset

Professor of Rheumatology, Rehabilitation, and Physical Medicine - ASU

Radwan Gamal El-Din

Assistant Professor of Orthopedic Surgery - ASU

Somaia M. Ebeid

Professor of Geriatrics and Gerontology - ASU

15 min	Ortho: Preoperative Nutritional Optimization in Orthopedic Surgery	Haytham Adel	Lecturer of Orthopedic Surgery - ASU
15 min	Geriatric Medicine: Aging: Nutritional Challenges	Somaia M. Ebeid	Professor of Geriatrics and Gerontology - ASU
15 min	Derma: Role of Diet in Immune-mediated Skin Diseases	Maysoon Assem	Assistant Lecturer of Dermatology - ASU
15 min	Neurology: Obesity in Neurological Disorder	Mohamed Khaled	
15 min	Rheumatology, Rehabilitation and Physical Medicine: Obesity and Autoimmunity	Howayda Farouk	Lecturer of Rheumatology, Rehabilitation, and Physical Medicine - ASU

Friday 26 April 2024



10:15 – 11:30

TIME FOR SCREENING OF LUNG CANCER

CHAIRPERSONS

Tarek Hussien
Ahmed Mostafa
Nesreen Mosallam

20 min	International Screening Recommendations	Gihan Elassal
20 min	Screening Versus Detection of Early Lung Cancer Lesions in LMIC	Mohamed Darwish
20 min	Can we Screen for Mesothelioma in High-Risk Region?	Ahmed Adel
20 min	Smoking Cessation Programs: Where are we?	Mahmoud Elhabiby

11:30 – 12:45

PARADIGM CHANGES IN EARLY NSCLC

CHAIRPERSONS

Emad Koraa
Sherif Abd El Wahab
Waheed Tantawy

20 min	Management of Incidental Lung Nodule	Yasmine Abdeldayem
20 min	EBUS and Bronchoscopy in Lung Cancer Diagnosis: Challenges and Solutions	Marwa Daif
20 min	Surgical Management of NSCLC: Can we Decrease the Morbidity?	Hany Hassan
20 min	Neoadjuvant and Adjuvant Updates in NSCLC: for whom?	Mai Ezz El Din

Friday 26 April 2024



14:00 – 15:45

NEUROLOGICAL DISORDERS: NOVEL INTERVENTIONS AND THERAPEUTIC STRATEGIES

CHAIRPERSONS

Mervat Abdelhakim Professor of Rheumatology, Rehabilitation, and Physical Medicine - ASU
 Salah Abdel-Khalek Professor of Neurological and Spine Surgery, ASU
 Shady Samir Professor of Orthopedic Surgery - ASU
 Shahira El-Fedawy Head of Clinical Pathology Department - ASU

15 min	Clinical Pathology: Neuro-Immune Connection: Diagnostic Breakthroughs in Neurologic Disorders"	Yasmeen Hamdy	Asst. Lecturer of Clinical Pathology - ASU
15 min	Radio: Novel Interventions and Therapeutic Strategies Endovascular Management of Carotid Cavernous Fistula	Amr Mahmoud	
15 min	Neurosurgery: Neuroendovascular Intervention for Complex Intracranial Aneurysms.	Mohamed Alaa Habib	Professor of Neurosurgery and Neuro-Endovascular Interventions - ASU
15 min	Neurosurgery: Different Therapeutic Strategies for Parkinson's disease, Ablative Procedures and Deep rain Stimulation (DBS)	Aly Ibrahim	Lecturer of Neurosurgery and Functional Neurosurgery - ASU
15 min	Rheumatology, Rehabilitation and Physical Medicine: Innovations in Stroke Rehabilitation	Shereen Fawaz	Assistant Professor of Rheumatology, Rehabilitation, and Physical Medicine – ASU
15 min	Ortho: Recent Trends in Management of CP: Orthopedic Aspects	Mostafa Baraka	Assistant Professor of Orthopedic Surgery - ASU
15 min	Neurology: Advances in Management of Intracranial Atherosclerotic Disease.	Rady Youssef	

Friday 26 April 2024



15:45 – 17:30

THE CHALLENGE OF CHRONIC PAIN

CHAIRPERSONS

Ayman Abdel Fattah
Ghada Essam El-Din
Mohamed Mezied
Sherif Habib

Head of Family Medicine Department, Professor of Community, Environmental, and Occupational Medicine - ASU
Professor of Orthopedic Surgery - ASU
Professor of Obstetrics & Gynecology - ASU

15 min	VASC: Pelvic Congestion Syndrome	Ayman Abdel Fattah	
15 min	Gyn: Pelvic Congestion Syndrome	Ayman Abou Elnour	Professor of Gynecology & Obstetrics - ASU
15 min	Radio: Pelvic Venous Congestion	Rana Tarek Khafagy	
15 min	Neurosurgery: The use of Spinal Cord Stimulation (SCS) for Chronic Spinal pain.	Mohamed Amgad	Lecturer of Neurosurgery - ASU
15 min	Ortho: The back pain dilemma	Mohamed Aly Ibrahim	Assistant Professor of Orthopedic Surgery - ASU
15 min	AN: Percutaneous Lumbar Adhesiolysis "a light in a tunnel"	Amr Abdel Fattah	Professor of Anaesthesia, Intensive Care and Pain Management - ASU
15 min	Family medicine : Effectiveness of Integrated Education and Relaxation Program on Migraine Related Disability	Sara Hisham	Lecturer of Family Medicine - ASU

Friday 26 April 2024



17:30 – 19:15

MENTAL HEALTH MATTERS: NOVEL APPROACHES IN PSYCHOLOGICAL THERAPIES

CHAIRPERSONS

Sawsan Aboul-Fotouh
Seham Fouad

Professor of Clinical Pharmacology and Psychiatrist - ASU
Professor of Forensic Medicine and Toxicology - ASU

15 min	Forensic: Ethical issues in Forensic Psychiatry	Hanan Elsayed	Assistant Professor of Forensic Medicine and Toxicology - ASU
15 min	CEOM: Presenteeism: The Timeless Occupational Health Threat	Mostafa El-Shahed	Lecturer of Occupational Medicine - ASU
15 min	CEOM: Healthy working Environment - Getting on Doctor, Doctor Relationship	Omar Matar	Administrator of Epidemiology - ASU
15 min	Pharma: Antidepressants update: Fast Non-Monoaminergic Targeted Antidepressant drugs	Sawsan Aboul-Fotouh	
15 min	Psychiatry: Management of Depression: the untold story.	Hisham Ramy	
15 min	Psychiatry: Psychotherapeutics Interventions in Management of Depression: The Neglected Dimension.	Mariam Yehia	
15 min	Derma: Impact of Depression on Semen Parameters	Nada Salah	Assistant Lecturer of Dermatology - ASU

Friday 26 April 2024



09:00 - 10:15

IMMUNOLOGY SESSION

CHAIRPERSONS

Mayada Moneer Mahmoud
Mohamed El-Shayeb
Omnia Zeyada
Sara Said Ragab

Assistant Professor of Internal Medicine, Allergy and Clinical Immunology - ASU
Professor of Internal Medicine, Allergy and Clinical Immunology - ASU
Lecturer of Internal Medicine, Allergy and Clinical Immunology - ASU
Lecturer of Internal Medicine, Allergy and Clinical Immunology - ASU

15 min	Angioedema general overview	Eman Naguib El-Mahdi	Professor of Internal Medicine, Allergy and Clinical Immunology - ASU
15 min	Mast cell mediated angioedema	Nermin Moheb	Lecturer of Internal Medicine, Allergy and Clinical Immunology - ASU
15 min	Bradykinin mediated angioedema	Ahmed Yehia	Lecturer of Internal Medicine, Allergy and Clinical Immunology - ASU
15 min	Recent advances in treatment of angioedema	Manar Farouk Mohamed	Assistant Professor of Internal Medicine, Allergy and Clinical Immunology - ASU
15 min	Angioedema mimickers (presented as cases first case classic angioedema then other cases mimics (Virtual)	Amaal Asad	Professor of Pediatrics – University of Cincinnati – Division of Allergy and Immunology – Cincinnati Children Hospital

Friday 26 April 2024



10:30 – 12:00

GUT- RHEUMATOLOGY INTERPLAY SESSION

CHAIRPERSONS

- Amal Shawky** Professor of Internal Medicine and Gastroenterology - ASU
- Amira Salem** Professor of Internal Medicine and Gastroenterology - ASU
- Dahlia Abdel Mohsen** Professor of Internal Medicine and Rheumatology - ASU
- Marcil William** Professor of Internal Medicine and Gastroenterology - ASU
- Rasha Mohamed Hassan** Assistant Professor of Internal Medicine and Rheumatology - ASU
- Samah El-Bakry** Professor of Internal Medicine and Rheumatology - ASU

MODERATORS

- Hagar Elessawy** Assistant Professor of Internal Medicine and Gastroenterology - ASU
- Nermeen Noshy** Assistant Professor of Internal Medicine and Rheumatology - ASU

15 min	Enteropathic arthritis. How to know	Mohamed Maher	Lecturer of Internal Medicine and Rheumatology – ASU
15 min	Diarrhea Associated Rheumatological Condition	Khaled Hamdy	Professor of Internal Medicine and Gastroenterology - ASU
15 min	Case 1 and Discussion	Tasneem Elsaid	Assistant Lecturer of Internal Medicine and Rheumatology - ASU
15 min	Case 2 and Discussion	Noran Mohamed	Lecturer of Internal Medicine and Gastroenterology -ASU
20 min	Pfizer Symposium: Xeljanz in Rheumatoid Arthritis	Samah El-Bakry	Professor of Internal Medicine and Rheumatology - ASU



Friday 26 April 2024



14:00 – 15:15

HEMATOLOGY SESSION

CHAIRPERSONS

Abdelrahman Soliman
Amal Afifi
Essam Abdelwahed
Neveen Nabil
Rasha Magdy

Professor of Hematology and BMT, Internal Medicine Department - ASU
Professor of Hematology and BMT, Internal Medicine Department - ASU
Professor of Hematology and BMT, Internal Medicine Department - ASU
Professor of Hematology and BMT, Internal Medicine Department - ASU
Asst. Professor of Hematology and BMT, Internal Medicine Department - ASU

15 min	New Advanced Therapy in Sickle Cell Disease	Nermeen Adel	Professor of Hematology and BMT, Internal Medicine Department - ASU
15 min	Thrombophilia, what's new?	Neveen Nabil	Professor of Hematology and BMT, Internal Medicine Department - ASU
15 min	Thrombophilia: Case Presentation	Hanaa Fathy	Professor of Hematology and BMT, Internal Medicine Department - ASU
15 min	Updated Review of CLL	Rana Gamal	Lecturer of Hematology and BMT, Internal Medicine Department - ASU
15 min	Advanced Treatment in Hemophilia	Heba Magdy	Lecturer of Hematology and BMT, Internal Medicine Department - ASU

Friday 26 April 2024



15:15 – 16:15

GASTROENTEROLOGY AND HEPATOLOGY UPDATES

CHAIRPERSONS

Ahmed Shawky	Professor of Internal Medicine, Gastroenterology and Hepatology - ASU
Azza Emam	Professor of Internal Medicine, Gastroenterology and Hepatology - ASU
Enas Foda	Professor of Internal Medicine, Gastroenterology and Hepatology - ASU
Nevine Mousa	Professor of Internal Medicine and Hepatology - ASU
Osama Ashraf	Professor of Internal Medicine, Gastroenterology and Hepatology - ASU
Sayed Shalaby	Professor of Internal Medicine, Gastroenterology and Hepatology - ASU
Tarek Maged	Professor of Internal Medicine, Gastroenterology and Hepatology - ASU

MODERATOR

Mohamed Magdy Salama	Associated Professor of Internal Medicine, Gastroenterology and Hepatology - ASU
-----------------------------	--

15 min	A difficult to Treat Case of DILI"as a Case Report	Osama Aboelfotouh	Professor of Internal Medicine, Gastroenterology and Hepatology – ASU
15 min	Recent updates in NAFLD	Essam Bayoumi	Professor of Internal Medicine, Gastroenterology and Hepatology – ASU
15 min	Recent update in H Pylori Infection	Tarek Youssef	Professor of Internal Medicine, Gastroenterology and Hepatology - ASU
15 min	Recent updates in Refractory Constipation	Rasha Samir	Associated Professor of Internal Medicine, Gastroenterology and Hepatology - ASU

Friday 26 April 2024



16:15 – 17:30

INTEGRAL ROLE OF KIDNEY IN MEDICAL DISEASE

CHAIRPERSONS

- | | |
|-------------------|---|
| Atef Abdel Hamid | Professor of Vascular Surgery |
| Cherry Reda | Professor of Internal Medicine and Nephrology - ASU |
| Hayam Hebah | Professor of Internal Medicine and Nephrology - ASU |
| Hisham Abo Elliel | Professor of Internal Medicine and Nephrology - ASU |
| Magdy Elsharkawy | Professor of Internal Medicine and Nephrology - ASU |
| Mohamed Halawa | Professor of Internal Medicine and Nephrology - ASU |
| Walid Bishary | Professor of Internal Medicine and Nephrology - ASU |

15 min	Kidney & DM	Iman Sarhan	Professor of Internal Medicine and Nephrology - ASU
15 min	Kidney & Hypertension	Walid Bishary	Professor of Internal Medicine and Nephrology - ASU
15 min	Kidney & Cardiovascular Disease	Tamer Wahid El-Said	Professor of Internal Medicine and Nephrology - ASU
15 min	AN: Overlap syndrome: Thrombotic Microangiopathies in Pregnancy	Rania Magdy	Professor of Anaesthesia, Intensive Care and Pain Management- ASU
15 min	Vasc: Failing AV access - Part of Kidney Replacement	Nader Hamada	Professor of Vascular Surgery

Friday 26 April 2024



17:45 – 19:00

FROM VISION TO REALITY: BRIDGING THE GAP BETWEEN INNOVATION AND CLINICAL PRACTICE IN SURGERY

CHAIRPERSONS

Hazem Ahmed Professor of Neurological and Spine Surgery, ASU
 Hesham El-Shawaf
 Mohamed Yassin Professor of Clinical Oncology - ASU

15 min	ENT: Oropharynx Approach: From Commando Operation to Transoral Robotic Surgery TORS	Lobna Alfeky	Professor of Otorhinolaryngology - ASU
15 min	Neurosurgery: Navigation in Brain and Spine surgery. A Long Journey Towards an Important Milestone.	Hazem Ahmed	Professor of Neurological and Spine Surgery - ASU
15 min	Urology: Progress in Robotic Surgery in Urology – Ain Shams Experience	Ahmed Emam	
15 min	Tropical		
15 min	Urology: Minimally Invasive Tools in Management of Prostatic Enlargement (Virtual)	Amr Emara	Consultant Urologist at Hampshire Hospitals NHS Foundation Trust

Friday 26 April 2024



09:00 - 10:30

FRAILITY: THE MYSTERIOUS GERIATRIC GIANT

CHAIRPERSONS

- Aisha Abo El-Fettouh** Professor of Community, Environmental and Occupational Medicine, ASU; Former Vice dean of Education and Students affairs - Faculty of Medicine - ASU
- Hala Sweed** Professor of Geriatrics and Gerontology & Vice Dean of Community Affairs and Environment – ASU
Former Head of Geriatrics and Gerontology Department - ASU
- Hoda Fahim** Professor of Community, Environmental and Occupational Medicine - ASU

15 min	Concepts, Definitions, and Diagnosis	Samia A Abdul-Rahman	Professor of Geriatrics and Gerontology - ASU
15 min	Common Presentations of Frailty	Mohamed Ahmad Alsadany	Professor of Geriatrics and Gerontology - ASU
15 min	Cognitive frailty: New Concepts	Nesma Gamal El-Sheikh	Assistant Professor of Geriatrics and Gerontology - ASU
15 min	Nutritional Interventions	Marwa Abdel Azeem	Lecturer of Geriatrics and Gerontology - ASU
15 min	Pitfalls in Management of Frail Patients	Walaa Wessam	Professor of Geriatrics and Gerontology - ASU
15 min	The Psychosocial Impact of Frailty for the older Adult.	William E.Hills	Professor of Psychology, Department of psychology, Coastal Carolina University, Conway, SC, USA

Friday 26 April 2024



10:30 – 12:00

CONCERNS IN PRACTICE

CHAIRPERSONS

Manar Maamoun
Nouran Abaza
Sonia Hammami

Head of Geriatrics and Gerontology Department - ASU
 Professor of Rheumatology, Rehabilitation, and Physical Medicine - ASU
 Professor of Internal Medicine and Geriatric Medicine - University of Monastir, Tunisia

15 MIN	Critically ill Patients: Care and Outcomes	Waleed Youssef Ashraf Al-Agamy	Professor of Anesthesia, Intensive Care and Pain Management - ASU Professor of Anesthesia, Intensive Care and Pain Management - ASU
15 MIN	Potential Therapeutics in Frailty	Mohamed Shawky Khater	Professor of Geriatrics and Gerontology Department - ASU
15 MIN	Rehabilitation of Osteo-sarcopenia: Insights for Clinician	Rehab Ali Ibrahim	Professor of Physical Medicine Rheumatology and Rehabilitation - ASU
15 MIN	New Management of Sarcopenia	Sonia Hammami	Professor of Internal Medicine and Geriatric Medicine - University of Monastir, Tunisia
15 MIN	Frailty in Palliative Care	Hesham Mosad	Lecturer of Geriatrics and Gerontology Department - ASU
15 MIN	Pathophysiology of Frailty in Diabetic Elderly	El-Sayed Ghonamy	Professor of Physiology - ASU

Friday 26 April 2024



14:00 – 15:45

AGING: A HEALTHCARE CHALLENGE

CHAIRPERSONS

Maha Hossam	Professor of Internal Medicine - Cairo University
Mohamed Farouk Allam	Professor of Family Medicine - ASU
Reem Elmallah	Professor of Rheumatology, Rehabilitation, and Physical Medicine - ASU
Somaia M. Ebeid	Professor of Geriatrics and Gerontology - ASU

15 min	Med Bio: Molecular biomarkers of Aging: An Update	Marwa Mostafa	Lecturer of Medical Biochemistry and Molecular Biology - ASU
15 min	Geriatrics: Why are elderly Patients a Challenging age Group?	Manar Maamoun	Head of Geriatrics and Gerontology Department - ASU
15 min	Geriatrics: Multimorbidity: Complexities and Approach	Maram Maher	Assistant Professor of Geriatrics and Gerontology - ASU
15 min	Geriatrics: Geriatric Syndromes	Abeer Abdel Zaher	Assistant Professor of Geriatrics and Gerontology - ASU
15 min	Med BIO: Alzheimer's disease: Recent update on Molecular and Biochemical Markers	Magda Ibrahim	Professor of Medical Biochemistry and Molecular Biology - ASU
15 min	Family Medicine: A typical Presentation of IHD in Elderly patient	Noha Tarek	Lecturer of Family Medicine - ASU
15 min	Rheumatology, Rehabilitation and Physical Medicine: Updates in management of Osteoporosis	Nevine Badr	Professor of Rheumatology, Rehabilitation, and Physical Medicine - ASU

15:45 – 17:15 GERIATRICS 3

PANEL DISCUSSION INTERACTIVE SESSION: FRAILITY IN PRACTICE

CHAIRPERSONS	Mohamed Ahmed Alsadany	Professor of Geriatrics and Gerontology - ASU
	Mohamed Shawky Khater	Professor of Geriatrics and Gerontology - ASU
	Walaa Wessam	Professor of Geriatrics and Gerontology - ASU

Friday 26 April 2024



17:15 – 19:00

**PRECISION MEDICINE:
 PERSONALIZED CARE FOR BETTER PATIENT OUTCOMES**

CHAIRPERSONS

Ahmed Abdel Salam El-Melegy Professor of Clinical Pharmacology - ASU
 Samia Abdou Professor of Clinical Pathology - ASU
 Shaimaa Youssef
 Yasmin Masoud

15 min	PATHOLOGY: The Role of Pathologist in Personalized Patient Care	Rana Ahmed	Lecturer of Pathology - ASU
15 min	Clinical pathology: Therapeutic Drug Monitoring of Antimicrobials; New role in Personalized Medicine	Omnia Mohamed	Professor of Clinical Pathology – ASU
15 min	Restoring Trust: The Need for Precision Medicine in Infectious Diseases	Nadia El-Sheshtawy	Professor of Medical Microbiology and Immunology - ASU
15 min	Tropical: Precision Medicine in Inflammatory Bowel Disease: Concept, Advancements, and Difficulties	Mohamed Altabbakh	
15 min	Pharma: Precision Medicine and Targeted Cancer Therapy	Ahmed Abdel Salam El-Melegy	Professor of Clinical Pharmacology - ASU
15 min	Dermatology: Atopic Dermatitis: Optimizing the use of Emerging Therapies	Mariam Adel	Assistant Lecturer of Dermatology - ASU
15 min	Dermatology: Exosomes: Is it really worth the hype?	Haitham Saleh	Assistant Lecturer of Dermatology -ASU

Friday 26 April 2024



10:00 - 11:30

AUDIOLOGY DEPARTMENT MULTIDISCIPLINARY APPROACH FOR MANAGEMENT OF LANGUAGE AND LEARNING PROBLEMS

CHAIRPERSON

Somaya Tawfik Professor of Audiology - ASU

15 min	Introduction	Somaya Tawfik	Professor of Audiology - ASU
15 min	Auditory processing Disorders in Language and Learning Problems	Amany Shalaby	Professor of Audiology - ASU
15 min	Learning and Reading Disorders, The real Causes from Phoniatics Point of View	Mona Hegazi	Professor of Phoniatics - ASU
15 min	ADHD & Learning Disabilities: Implications for Diagnosis	Azza Youssef	Professor of Pediatrics - ASU
15 min	Clinical Presentations of Learning Disabilities, How they Guide Phoniatics Rehabilitation	Mona Sameeh	Assistant Professor of Phoniatics - ASU
15 min	Discussion	Somaya Tawfik	Professor of Audiology - ASU

Friday 26 April 2024



14:00 – 15:30 ENT

CHAIRPERSONS

Ali Gamal Professor of Otorhinolaryngology - ASU
Ayman El-Kahky Professor of Otorhinolaryngology - ASU
Marium Ali Assistant Professor of Chest Diseases - ASU
Somaya Tawfik Professor of Audiology - ASU

15 min	Gene therapy in Sensorineural Hearing Loss	Ali Gamal Eldin	Professor of Otorhinolaryngology - ASU
15 min	Stem Cells in Sensorineural Hearing Loss	Ayman Elkhaky	Professor of Otorhinolaryngology - ASU
15 min	Updates on Fungal Sinusitis	Osama Mostafa	Assistant Professor of Otorhinolaryngology - ASU
15 min	Obstructive Sleep Apnea in Obese Patients	Mohamed Elsharnouby	Professor of Otorhinolaryngology - ASU
15 min	OSA from Pulmonary Perspectives	Marwa Hussein	Lecturer of Chest Diseases - ASU
15 min	Necrotizing Otitis Externa and Skull base Osteomyelitis in Diabetic Patients	Tahany Rabie	Assistant Professor of Otorhinolaryngology - ASU

15:30 – 17:00

**PHONiatrIcs ROUND TABLE DISCUSSION
 RECENT ADVANCES IN ASSESSMENT AND REHABILITATION OF AUTISM**

CHAIRPERSON **Nahla El-Refaie** Professor of Phoniatics - ASU

PANELISTS
Ahmed Nabil Assistant Professor of Phoniatics - ASU
Nirvana Hafez Professor of Phoniatics - ASU
Riham El-Husseini Assistant Professor of Pediatrics - ASU

Dysphagia in diabetes mellites (free paper)	Donia Adly	Lecturer of Phoniatics - ASU
---	------------	------------------------------

Friday 26 April 2024



18:30 – 20:15

HOW WE MANAGED THESE CASES: CASE PRESENTATIONS

CHAIRPERSONS

Iman Barakat

Mohamed Salah

Soha Raouf Youssef

Professor of Clinical Pathology - ASU

15 min	Clinical Pathology: Unmasking the Mystery of Insulin Surge in a Case Presentation.	Walaa Basouni Sleem	Assistant Lecturer Clinical Pathology - ASU
15 min	Clinical Pathology: The Dilemma of Immunoglobulin M Para-Proteinemia's: Clinical Case Report	Shams El-Doha Zaiema	Lecturer of Clinical Pathology - ASU
15 min	AN: TRALI in ITP patient postpartum: MDT Success Story	Wessam Zaher Selima	Lecturer of Anaesthesia, Intensive Care and Pain Management - ASU
15 min	Neurosurgery: Case series of Childhood Stroke, Moyamoya Disease Treatment.	Mohamed Alaa Habib	Professor of Neurosurgery and Neuro-Endovascular Interventions - ASU
15 min	Forensic: Evaluation of the new poisoning mortality score in comparison with PSS and SOFA scoring systems to predict mortality in poisoned patients admitted to the intensive care unit	Sara Saeed Mohamed	Lecturer of Clinical Toxicology - ASU
15 min	Pathology: Selected Pathology Case Presentation	Iman El-Gamal	Lecturer of Pathology - ASU
15 min	Tropical: HCC in Budd Chiari Patient	Heba Esmail	



ORGANIZING OFFICE IN CHARGE

Iris Events Management (Egypt)
Iris Excellence Conferences
& Exhibition Organizing (U.A.E)

M: + 2 010 111 2 111 2
+971 50 40 90 455

info@iriseventsmgt.com
www.iriseventsmgt.com

www.asumedicalcongress.com